



**TEXACO HAWAII**  
**HAWAII HIGH SCHOOL ATHLETIC ASSOCIATION**  
**WRESTLING STATE CHAMPIONSHIPS**  
Feburary 23-24, 2024  
George Q. Cannon Activities Center, Laie, HI

**TEXACO HAWAII  
HAWAII HIGH SCHOOL ATHLETIC ASSOCIATION  
WRESTLING STATE CHAMPIONSHIPS  
February 23-24, 2024**

**HAWAII HIGH SCHOOL ATHLETIC ASSOCIATION**

Executive Director .....Chris Chun  
Associate Director ..... Russ Aoki  
Director of Information ..... Natalie Iwamoto  
Wrestling Coordinator ..... Ed Paola & Maurice Maggolino

**TOURNAMENT COMMITTEE**

Tournament Director ..... Ed Paola & Maurice Maggolino  
Host School ..... Iolani School  
ILH Executive Director ..... Blane Gaison  
Rules, Scoring and Officials ..... Ed Paola, Maurice Maggolino & Bryan Akeo  
Protest Committee ..... Ed Paola, Maurice Maggolino, Bryan Akeo, Kimo Weaver & Chris Chun  
Awards and Ceremony ..... Texaco Hawaii  
Pairings and Assignments... Ed Paola, Maurice Maggolino, Rick Williams, Michael Chang & league representatives  
Weigh-In..... Ed Paola, Maurice Maggolino, Bryan Akeo & ~~Rick Williams~~, Michael Chang  
Announcers ..... Eddie Murayama, Kyle Miyamoto & Wayne Guevara  
Tournament Software & Results ..... Michael Chang, Ku'u Robinson  
Medical Personnel ..... OIA, ILH, BIIF, MIL, KIF Athletic Trainers  
Onsite Dermatologist..... Dr. Douglas Johnson

**SPECIAL THANKS**

Texaco Hawaii ..... Albert Chee, Jr, Manager, State & Local Relations, Hawaii  
..... Carina Tagupa, Community Relations Specialist  
George Q. Cannon Activities Center ..... Brandyn Akana

**TEXACO HAWAII  
HAWAII HIGH SCHOOL ATHLETIC ASSOCIATION  
WRESTLING STATE CHAMPIONSHIPS  
FEBURARY 23-24, 2024  
GEORGE Q. CANNON ACTIVITIES CENTER, LAIE, HAWAII**

**TOURNAMENT INFORMATION**

**I. HHSAA WRESTLING REGULATIONS**

HHSAA wrestling regulations may be found in the HHSAA Handbook found in this packet.

**II. LEAGUE REPRESENTATION**

League Representation as of 1/30/2024. See the League Representation section of [www.sportshigh.com](http://www.sportshigh.com) for current representation.

	<b>BOYS</b>	<b>GIRLS</b>
<b>OIA</b>	7	7
<b>ILH</b>	4	4
<b>BIIF</b>	5	5
<b>MIL</b>	3	3
<b>KIF</b>	1	1
<b>TOTAL</b>	20	20

**III. ENTRIES**

The deadline for team entries (for arena entry purposes) shall be 11:59 PM on Saturday, February 17, 2024. Entry into the George Q. Cannon Activities Center for all wrestlers, coaches, and managers shall be via the centers east side entrance only, and shall be pursuant to the entry list submitted by each school.

If no list is submitted by a school, only the wrestlers officially entered in the tournament and team coaches, as authorized by the school's athletic director, will be admitted in the George Q. Cannon Activities Center east side entrance. No additions to entry list will be accepted on the days of the tournament, and coaches and managers may be required to produce identification with photo for verification purposes.

**IV. SEEDING/PAIRING COMMITTEE**

The Seeding/Pairing Committee Meeting will be held at **Kamehameha Schools-Kapalama Campus, Athletics Building classroom 302 at 1:00 p.m. on Sunday, February 18, 2024. Leagues are required to submit electronically a spreadsheet (preferred format is Excel) with the results of the respective league wrestling tournament results not later than 7:00 a.m. on the day following their league Championships.** Additionally, representatives are requested to bring ten copies of their respective league wrestling tournament results to the meeting. Wrestler's weight class, first and last name, school, grade level, and placement are requested in typed format.

**V. SESSIONS**

- Day One**            Preliminary Round  
                         Quarter-Finals and Consolation Round One  
                         Consolation Round Two
  
- Day Two**            Semi-Finals and Consolation Quarter Finals  
                         Consolation Semi-Finals  
                         Championship and Consolation Finals

**VI. SCHEDULE AT GEORGE Q. CANNON ACTIVITIES CENTER**

**Friday, February 23, 2024**

Weigh-In.....10:00 am  
Coaches Meeting .....10:30 am  
Preliminary Round .....11:30 am

- \* Coaches meeting to be held concurrently with Weigh-Ins. Any modifications to the tournament brackets will be announced during the meeting.
- \* Consolation Round 3 may happen on Day 1 or Day 2. Decision will be made after seeding meeting.

Note: Scales will be made available to check weight at 9:15 a.m. – 9:45 a.m. Please refer to HHSAA’s “Weigh-In Procedures” (enclosed) for more specific information.

**Saturday, February 24, 2024**

Weigh-In.....10:00 am  
Coaches’ Meeting .....10:30 am  
Semifinals & Consolation Rounds 3 & 4.....11:00 am  
Championship & Consolation Finals .....4:00 pm

Note: Scales will be made available to check weight at: 9:15 a.m. – 9:45 a.m. Please refer to HHSAA’s “Weigh-In Procedures” (enclosed) for more specific information.

Awards will follow the completion of each weight class. All medal-winners are asked to wear appropriate attire for the awards presentation, or risk not being allowed to participate. Only lei will be allowed to be worn to the awards presentation with no hats or caps, signs, inflatables, or other extraneous adornments.

**VII. HOSPITALITY ROOM**

The Hospitality Room will only be available to authorized tournament personnel only. Coaches, wrestlers, and managers who are not official tournament personnel shall not be allowed entry into the Hospitality Room. The hospitality room is located in Classroom 218 on the second level.

## VIII. FACILITY REQUIREMENTS AND INFORMATION

George Q. Cannon regulations must be followed at all times:

1. Smoking/vaping is not allowed anywhere on campus. One must leave campus to smoke/vape.
2. Strollers, wagons, bikes, skateboards, etc. must be left outside the building.
3. Children must not be left unattended.
4. **Spectators are not allowed in locker room areas or surrounding hallways**

Cannon Center will be operating concession stands during the tournament. Only food bought from the concessions may be brought into the Cannon Center. Teams may setup team areas in the designated areas ONLY. Team area are on the east and south side on the outside of the Center. No teams shall setup on the North side (By the main entrance) of the center. In these designated areas there is to be no cooking or warming of food. All food from the teams area must be consumed outside in the team areas. No other areas are to be used by teams. All food must be prepackaged and bought from a licensed food provider. Also, the outside food and drinks are for consumption by wrestlers only, and are not to be shared with parents, friends, or any other spectators. Please use garbage cans for trash. Cannon Center has asked that teams clean up their areas. Please no gum in the Cannon Center.

Aisles, passageways and exits must always remain clear. No strollers, tripods, or other personal items may be placed in aisles. Exits and aisles must remain clear. Please follow the directions of the ushers and security. Smoking is not permitted in the Arena or on the Concourses.

Re-entry to the Cannon center is allowed with proper stamp and ticket scan out at the Pass Gate. Parking around the center is free an available on a first come basis.

## IX. CODE OF CONDUCT

The coach shall have direct responsibility for conduct of team members prior to, during and after tournament competition (in the hotel, in public, at the tournament, transporting to and from sites). Schools and individuals will be held liable for any damages incurred at the tournament site.

The HHSAA Executive Director may establish a common curfew hour as necessary.

The drinking of alcoholic beverages, smoking, drug use, loud, unruly or destructive behavior will not be tolerated.

Coaches are requested to inform their athletes of hotel rules and regulations. Please emphasize the importance of appropriate conduct and behavior and consideration for other hotel guests. Schools and students will be charged for any damages incurred by them at the hotel.

It is recommended that schools inform parents regarding the code-of-conduct in writing.

## X. STATE TOURNAMENT DISQUALIFICATION RULE

Any student-athlete or coach disqualified before, during, or after a state tournament game/match/event for unsportsmanlike conduct, flagrant verbal misconduct, or flagrant physical misconduct shall be disqualified from his/her next scheduled state tournament game/match/event for that sport. The student-athlete or coach has the right to appeal any such disqualification to an appeals committee for the particular sport. Should a student-athlete or coach be disqualified from the final state tournament game/match/event for that sport, said disqualification shall NOT carry over to the following school year's state tournament for that

sport. Instead, the student-athletes or coach's league shall determine any appropriate penalty or sanction.

## XI. STATE TOURNAMENT PROTEST PROCEDURES

In the event a coach decides that he/she would like to protest a match, the following procedures shall prevail:

- A. The coach shall inform the referee in charge of the match that the match is being protested.
- B. The referee shall, without hesitation or consultation with any officials other than the assistant referee, go directly to the tournament head table and inform the Tournament Director that the match is being protested. The referee shall communicate the nature of the protest, which teams, coaches and athletes are involved in the protested match.
- C. The Tournament Director shall immediately convene a meeting of the protest committee. The meeting shall be held at a location which shall facilitate clear communications without intrusion by non-involved parties. Should the meeting be held away from the mat, the assistant referee or other idle referee shall manage the mat and contestants during the time the protest committee is considering its decision.
- D. During the meeting, which shall be led by the Tournament Director, each party shall have an opportunity to address the protest committee. The protesting party shall have first opportunity, followed by the opposing party, followed by the referee in charge of the match. The assistant referee may be consulted by the protest committee to validate the various points of consideration.
- E. The protest committee shall meet and make a final decision. The Tournament Director, or designee, shall deliver the decision to the parties. The decision of the protest committee shall be final and not subject to further review or consideration. Any additional wrestling, penalty, scoring adjustment, or action resulting from the decision will be conducted in accordance with the NFHS Wrestling Rule Book.

## SCHOOL ABBREVIATIONS

HHSAA APPROVED SCHOOL CODES		
CODE	SCHOOL	LEAGUE
AIE	Aiea	OIA
ANE	Anuenue	OIA
AOP	Academy of the Pacific	ILH
AST	ASSETS	ILH
BAL	Baldwin	MIL
CAM	Campbell	OIA
CAS	Castle	OIA
CHA	Christian	ILH
CLA	Christian Liberty	BIIF
DMN	Damien	ILH
FAR	Farrington	OIA
HAN	Hana	MIL
HAS	Hawaii of Arts & Science	BIIF
HBA	Hawaii Baptist	ILH
HCD	Hawaii Center for the Deaf & Blind	OIA
HIL	Hilo	BIIF
HKM	Halau Ku Mana	OIA
HNL	Hanalani	ILH

HOA	Hoala	ILH
HON	Honokaa	BIIF
HOW	Honolulu Waldorf	ILH
HPA	Hawaii Preparatory	BIIF
IOL	Iolani	ILH
IPA	Island Pacific	ILH
ISL	Island School	KIF
KAH	Kahuku	OIA
KAI	Kauai	KIF
KAN	Ke Ana La'ahana	BIIF
KAP	Kapaa	KIF
KAS	Kaiser	OIA
KAU	Ka`u	BIIF
KEA	Kealakehe	BIIF
KEU	Keaau	BIIF
KIH	Kihei	MIL
KIL	Kailua	OIA
KIM	Kaimuki	OIA
KIN	King Kekaulike	MIL
KKS	Ke Kula o Samuel Kamakau	OIA
KLH	Kalaheo	OIA
KLN	Kalani	OIA
KNC	Kanu `O Ka `Aina New Centry	BIIF
KOH	Kohala	BIIF
KON	Konawaena	BIIF
KPO	Kapolei	OIA
KSH	Kamehameha - Hawaii	BIIF
KSK	Kamehameha - Kapalama	ILH
KSM	Kamehameha - Maui	MIL
KUL	Kula	KIF
LAH	Lahainaluna	MIL
LAN	Lanai	MIL
LAP	La Pietra	ILH
LAU	Laupahoehoe	BIIF
LEI	Leilehua	OIA
LEJ	Le Jardin	ILH
LNK	Lanakila Baptist	ILH
LUT	Lutheran	ILH
MAR	Maryknoll	ILH
MAU	Maui	MIL
MBT	Myron B. Thompson	OIA
MCK	McKinley	OIA
MIL	Mililani	OIA
MLC	Makua Lani Christian	BIIF
MOA	Moanalua	OIA
MOC	Molokai Christian	MIL
MOL	Molokai	MIL

MPI	Mid Pacific	ILH
NAN	Nanakuli	OIA
PAC	Pac Five	ILH
PAH	Pahoa	BIIF
PAR	Parker	BIIF
PBA	Pacific Buddhist	ILH
PEC	Pearl City	OIA
PRI	St. Andrew's Priory	ILH
PUN	Punahou	ILH
RAD	Radford	OIA
RED	Redemption	ILH
ROS	Roosevelt	OIA
SEA	Seabury Hall	MIL
SHA	Sacred Hearts	ILH
STA	St. Anthony	MIL
STF	St. Francis	ILH
STJ	St. Joseph	BIIF
STL	Saint Louis	ILH
UHS	University	ILH
WAK	Waiakea	BIIF
WAL	Waialua	OIA
WAM	Waimea	KIF
WAN	Waianae	OIA
WAP	Waipahu	OIA
WHE	West Hawaii Explorers	BIIF



# WRESTLING CHAMPIONSHIP

Wt. Class \_\_\_\_\_

## Consolation

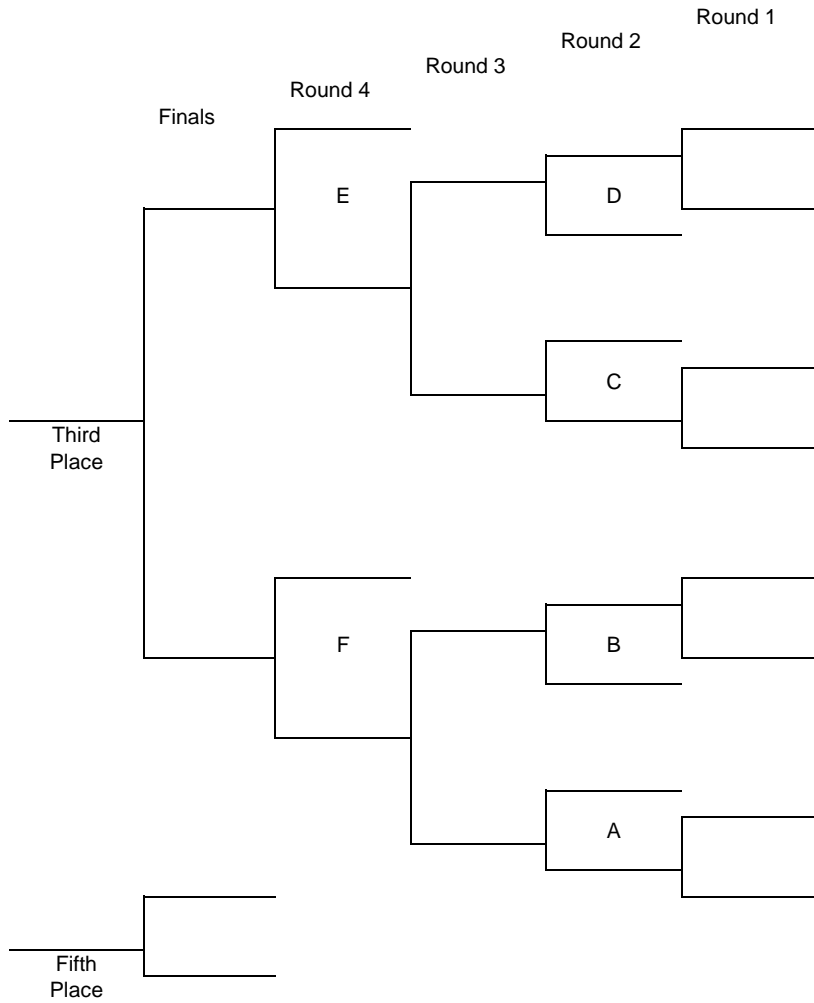

## Championship

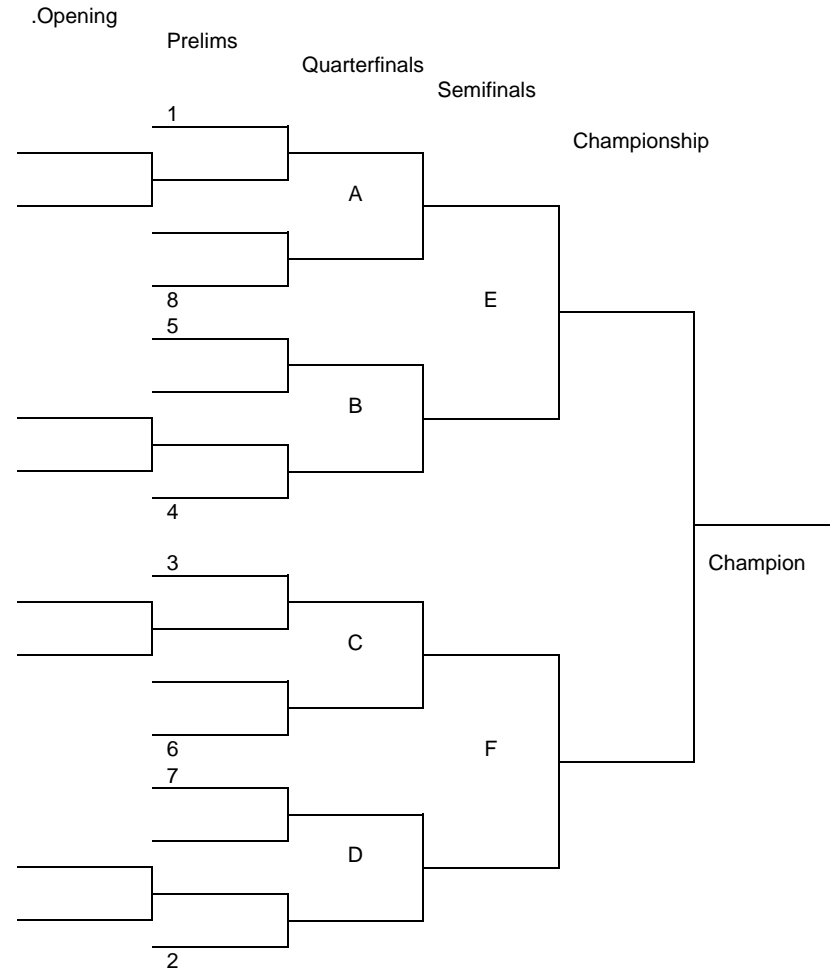

# HAWAII HIGH SCHOOL ATHLETIC ASSOCIATION

## STATE WRESTLING

### Weigh-In Rules

The NFHS Wrestling Rules Book for 2018-19 provides in Rule 4, Section 5, Articles 3-9 –ART 3...For any event, all contestants shall be present in and remain in the designated weigh-in area unless permission is granted by the meet administration. When all wrestlers for a weight class have had an opportunity to weigh in and the next class is called, that weight class is closed. Tournament weigh-in may proceed by team(s) with the lowest weight class to the highest and end immediately upon the completion of the highest weight class. A contestant shall weigh in for only one weight class during the weight in-in period. If only one scale is available, a contestant may step on and off of that scale two times to allow for mechanical inconsistencies in the scale. If multiple scales are available, a contestant may step on and off of the first scale two times to allow for mechanical inconsistencies in that scale. If the contestant fails to make weight on the first scale, the contestant shall immediately step on each available scale one time in an attempt to make weight. During time off the scale(s), activities that promote dehydration, weight loss or weight gain are prohibited.

ART 4...The referee, or other authorized person of the same gender, shall supervise the weight-ins.

ART 5...When there are consecutive days of team competition, there shall be a 1-pound additional allowance granted each day for all wrestlers up to a maximum of 2 pounds.

Art 6...A contestant representing a school in an individually bracketed tournament shall be named by weight class prior to the conclusion of the weight-in.

ART 7 . . . All contestants shall weigh-in wearing a legal uniform (4-4-1) and a suitable undergarment that completely covers the buttocks and the groin area. Contestants shall not weigh-in wearing shoes or ear guards. Female contestants shall also wear a suitable form-fitted compression undergarment that completely covers their breasts. Contestants may wear ~~low-cut~~ socks that cannot be removed or added if the wrestlers do not make weight.

**NOTE:** No additional weight allowance shall be granted for weighing-in wearing a legal uniform.

ART 8...Any contestant failing to make weight during the weigh-in period shall be ineligible for that weight class.

ART 9... Any contestant who has been authorized to wear an artificial limb, shall weigh-in with the artificial limb." This clarification has been written to ensure that all athletic directors, coaches, wrestlers and officials clearly understand the implication of the new rule

## WRESTLING

### I. SPECIFIC OBJECTIVES

- A. To determine the state individual and team championships.
- B. To promote interest in wrestling on the part of students, school, and community.
- C. To promote individual, team, school and spectator citizenship.

### II. OFFICIALS

#### A. Selection and Assignments

- 1. Officials must have taken the National Federation test.
- 2. Officials may be selected from all leagues. Names of qualified officials may be sent to the HHSAA Executive Director either by the League's Executive Secretary or representative.
- 3. Selection and assignments of officials shall be made by the HHSAA Executive Director and Sport Coordinator using a Referee's Ranking system. (Rev. 6/2012)

#### B. Financial Allowance

- 1. Referees shall be paid based on HHSAA rates.
- 2. Assistant referees will be used for Consolation Round three, Round four, Semi Finals and Final matches.
- 3. For the finals, officials will rotate as referee, assistant referee, and scorer's table advisor. A minimum of twelve officials will be used for the 2<sup>nd</sup> day. Officials will serve as official timekeepers. Officials will be selected and placed accordingly by the HHSAA Executive Director and Sport Coordinator.
- 4. Officials shall be assigned to handle the weigh-in sessions. Three officials per scale are recommended for each session.

#### C. Uniform

- 1. All state tournament officials/umpires shall wear uniforms in accordance with their sport's NFHS rules/guidelines/recommendations. In the absence of any NFHS rules/guidelines/recommendations, the sport's HHSAA Sport Coordinator shall have the final say as to the appropriateness of a state tournament official's/umpire's uniform.

### III. ELIGIBILITY (SEE HHSAA HANDBOOK)

### IV. RULES GOVERNING THE TOURNAMENT

- A. The National Federation Wrestling Rules shall govern the tournament, with HHSAA modifications as needed, including the HHSAA's Wrestling Weight Monitoring Program which was implemented to be in compliance with the NFHS rules (Rule 1, Section 3. Weight Control Program).
- B. Weight-monitoring program
  - 1. For Weight Monitoring Program purposes, wrestlers can only be tested by their respective league's athletic trainers (or other representatives), and not those of another league. The number and scheduling of the respective league's testing dates shall be set by each respective league.

2. One retest will be allowed for wrestlers who establish a minimum weight that is within one pound over their minimum weight class. Testing will occur with each league's hydration testing period.  
Example: A wrestler passes hydration and establishes a minimum weight of 108.4. They will be allowed to retest one more time because they are within one pound of the 108-lb. weight class as opposed to being forced to wrestle up at the 114-lb. weight class. (Rev. 6/2013)
- C. HHSAA-approved Addition to the National Federation Wrestling Rules (added June 2010) - If a defensive wrestler in a near-fall situation signals with the "tap-out" gesture, and the match is stopped because of the signal, then the wrestler will default the match, except if the tap-out gesture is due to an illegal hold on the part of the offensive wrestler.
  - D. Coaches are reminded to instruct their athletes of the host school's gym or arena regulations and to abide by these regulations.
  - E. For injury time, have the timer (or assistant referee, if available) give a loud verbal countdown of the amount of time left at 15 second intervals.
  - F. The host school at a wrestling site shall be responsible for a stopwatch at each scoring table. The host school can provide the stopwatches or ask the participating schools to provide them. For example, if three dual meets are being held simultaneously at one site, the host school can provide all three stopwatches or ask the other schools to provide them.
  - G. A timekeeper shall be on the wrestling mat during injury/bleeding time outs to assist the wrestling official, athletic trainer, and coaches. The timekeeper's only responsibility during the time shall be to keep track of the injury/bleeding time and to verbally announce such time at the intervals of: one minute, 1:15, and at the expiration of the injury/bleeding time out.
  - H. The injured/bleeding wrestler must be ready to wrestle (e.g. shoelaces must be tied and taped) by the conclusion of the injury/bleeding time out.
  - I. The final decision as to whether an injured wrestler shall continue to compete in his/her wrestling match shall be made by the attending athletic trainer.
  - J. The wrestling season will be a minimum of 15 weeks. (Rev. 6/2012)
  - K. One coach will be able to be with their wrestlers while in the staging area. (Rev. 6/2014)
  - L. A dermatologist provided by the HHSAA shall be onsite for weigh-ins on both days of the tournament. (Rev 6/2015)
  - M. Any student-athlete or coach disqualified before, during or after a state tournament game/match/event for unsportsmanlike conduct, flagrant verbal misconduct, or flagrant physical misconduct shall be disqualified from his/her next scheduled state tournament game/match/event for that sport. The student-athlete or coach has the right to appeal any such disqualification to an appeals committee for the particular sport. Should a student-athlete or coach be disqualified from the final state tournament game/match/event for that sport, said disqualification shall NOT carry over to the following school year's state tournament for that sport. Instead, the student-athletes or coaches league shall determine any appropriate penalty or sanction. (Rev. 06/2013)

#### V. TOURNAMENT FORMAT AND TIME SCHEDULE

- A. Type of tournament - Double-Elimination held on two days. All contestants losing in the championship rounds will move into the consolation rounds. All contestants losing in the consolation rounds will be eliminated except those competitors wrestling for 5<sup>th</sup> place. (SEE ATTACHED BRACKET)
- B. There shall be a maximum of 20 entries in each weight classification.

C. The 14 Boys weight classifications (at scratch weight) are:

- |            |             |             |
|------------|-------------|-------------|
| 1. 106 lb. | 6. 138 lb.  | 11. 175 lb. |
| 2. 113 lb. | 7. 144 lb.  | 12. 190 lb. |
| 3. 120 lb. | 8. 150 lb.  | 13. 215 lb. |
| 4. 126 lb. | 9. 157 lb.  | 14. 285 lb. |
| 5. 132 lb. | 10. 165 lb. |             |
- ~~(Rev. 6/2013)~~ Rev (6/2023)

The 14 Girls weight classifications (at scratch weight) are:

- |            |             |             |
|------------|-------------|-------------|
| 1. 100 lb. | 6. 125 lb.  | 11. 155 lb. |
| 2. 105 lb. | 7. 130 lb.  | 12. 170 lb. |
| 3. 110 lb. | 8. 135 lb.  | 13. 190 lb. |
| 4. 115 lb. | 9. 140 lb.  | 14. 235 lb. |
| 5. 120 lb. | 10. 145 lb. |             |
- ~~(Rev. 6/2014)~~ Rev (6/2023)

Adding two/four fishtails/qualifiers back into state tournament weight classes *(adopted 06/2018)*

A two-pound growth allowance is made effective the first Sunday of January *(adopted 06/2018)* and effectively increases all weight classifications by two pounds (NFHS Wrestling Rules, Rule 4, Section 4, Article 4, and NFHS Wrestling Case/Manual, 4.4.4 Situation). (Rev 6/2019)

D. Scoring

1. National Federation scoring to prevail.
2. All scoring should be kept in full view of contestants, coaches and spectators, whenever possible.

E. Sessions

- |           |  |
|-----------|--|
| Day One - | Preliminary Round<br>Quarter-Finals and Consolation Round One<br>Consolation Round Two                   |
| Day Two - | Semi-Finals and Consolation Round Three<br>Consolation Round Four<br>Championship and Consolation Finals |

F. Tournament Site(s)

1. The ILH and OIA leagues shall rotate in hosting the HHSAA Wrestling Tournament on Oahu, unless otherwise agreed upon by the HHSAA, ILH, and OIA.
2. The HHSAA Executive Director shall select the tournament site(s).
3. A centralized location for a tournament is recommended in order to minimize the problem of hauling the mats that are required to conduct the tournament.
4. Neal Blaisdell Center or Stan Sheriff Center should be used for the final day, whenever possible.

G. Length of Matches

1. The matches shall consist of three two-minute (2-2-2) periods.
2. Qualifying and consolation rounds shall be one-two-two (1-2-2) minute periods.

3. No contestant shall be required to wrestle two matches with less than 30 minutes between matches.

H. Explanation of Illustration

1. Preliminary round winners will move to Quarterfinals and losers will move to Consolation Round 1.
2. Winners in the championship rounds will continue to progress towards the championship. Losers in the Quarterfinal Round will cross-bracket to Consolation Round 2 as indicated by the corresponding letters. Losers in Semi-Final Round will move directly to Consolation Round 4 without crossing.
3. Losers in Consolation Round 4 will move to the 5th place match. All losers in Consolation Round 1, 2, and 3 will be eliminated.

VI. ENTRIES

- A. League slots are determined by the HHSAA formula: number of eligible teams in the league divided by the number of eligible participating teams in the state times 20 (slots for weight class.) (*revised 06/2018*)

$$\frac{\text{Number of Participating Teams in League}}{\text{Number of Participating Teams in State}} \times \text{Number of Slots per Weight Class}$$

- B. Each league shall determine the method of selecting their entries subject to the limitations of wrestlers allocated to their league.
- C. All entries into the HHSAA State Wrestling Tournament (including alternates) must be received by the State Wrestling Coordinator before the start of the seeding meeting. After this time, no other entries will be accepted. Leagues are encouraged to submit as many alternates as possible before this deadline. (Rev 6/2016)
- D. All wrestlers must wrestle in the weight division through which they qualified in their league championship. Each wrestler shall establish a certified minimum weight by the prescribed deadline and shall be prohibited from re-certifying at a lower weight during the same season. Wrestlers shall not wrestle more than one weight class above their actual weight at weigh-in. They shall not wrestle below their certified weight class. A copy of the certified weight list should also be sent to the Executive Director of each league prior to their league tournament.
- E. A league slot that opens up shall be filled by another wrestler from that league. In the event that a league cannot fill a slot, an alternate wrestler from another league shall be selected by a rotation to be determined each year at the state seeding meeting. The order of rotation does not carry over from one year to the next. The rotation for the girls' tournament is separate from the rotation from the boys' tournament.

VII. UNIFORM

- A. Follow the National Federation Standards.
- B. Any exception to the uniform rule must be cleared with the HHSAA Sport Coordinator and approved by the HHSAA Executive Director.
- C. Head covers that fasten or tied under the chin are required for those having hair longer than allowed.

VIII. SIZE OF TRAVELING TEAMS

Schools may bring qualifying wrestlers, including alternates, accompanied by authorized coaches, managers and trainers. Names of coaches, managers, trainers, and wrestlers must be listed on the official tournament roster forms.

Additional coaches, managers, trainers and wrestlers not on the official roster may enter at the team gate with an athletic director-approved list and with payment for those individuals. Payment will be based on the admission fees noted in Section XII of the wrestling handbook.

IX. SEEDING/PAIRING COMMITTEE

A. The Committee shall consist of:

1. HHSAA Executive Director (or designee)
2. HHSAA Sport Coordinator
3. A representative from each league
4. Other personnel selected by the Sport coordinator and approved by the HHSAA Executive Director

B. The Seeding/Pairing committee shall be responsible for all pairing and seeding procedures.

The top eight seeds in all weight classes will be seeded using seeding criteria, and the remaining state qualifiers in the weight class (max. 12) will be drawn in, with the remainder of the league participants evenly separated by half bracket, with no league competing against itself in the qualifying round (ex. OIA v. OIA), where possible. Each league champion will be the top-seeded wrestler from that league. (Rev 6/2023)

1. Head-to head in current season
  2. Comparison based on common opponents in current or another weight class (in current season)
  3. Returning state champion (current weight class)
  4. Returning state champion (any weight class)
  5. Highest returning state placer (in any weight class top 6)
  6. Highest returning state placer (in current weight class top 6)
  7. Coaches vote
  8. Coin flip
- (Rev 6/2023)

X. AWARDS AND TROPHIES

- A. Permanent trophy for the championship team.
- B. Permanent trophy for the runner-up team.
- C. 16 medals for the championship team.
- D. Medals for the six places in each weight classification.
- E. A group picture of the 14 Individual Boys Champions and the 11 individual Girls Champions should be taken at the conclusion at the tournament for national wrestling publications.
- F. Coaches are requested to see that the athletes are properly dressed for the awards ceremony. No balloons, banners, hat, caps, beanies, or other accessories beyond lei will be allowed.

XI. TOURNAMENT EVALUATION

The Sport Coordinator and Tournament Director shall submit an evaluation report and results of the tournament to the HHSAA Executive Director within two weeks after the tournament.

XII. ADMISSION

General Admission                      \$9.00\*  
\*plus applicable service fees

Participating wrestlers, coaches and team managers must be listed on the Official Roster Form for free admission to the tournament.

MAIN ENTRANCE  
FOR SPECTATORS



TEAM  
ENTRANCE



- 1000
- 2000
- 3000
- 4000
- 5000
- 6000
- 7000
- 8000
- 9000
- 10000
- 11000
- 12000
- 13000
- 14000
- 15000
- 16000
- 17000
- 18000
- 19000
- 20000
- 21000
- 22000
- 23000
- 24000
- 25000
- 26000
- 27000
- 28000
- 29000
- 30000
- 31000
- 32000
- 33000
- 34000
- 35000
- 36000
- 37000
- 38000
- 39000
- 40000
- 41000
- 42000
- 43000
- 44000
- 45000
- 46000
- 47000
- 48000
- 49000
- 50000

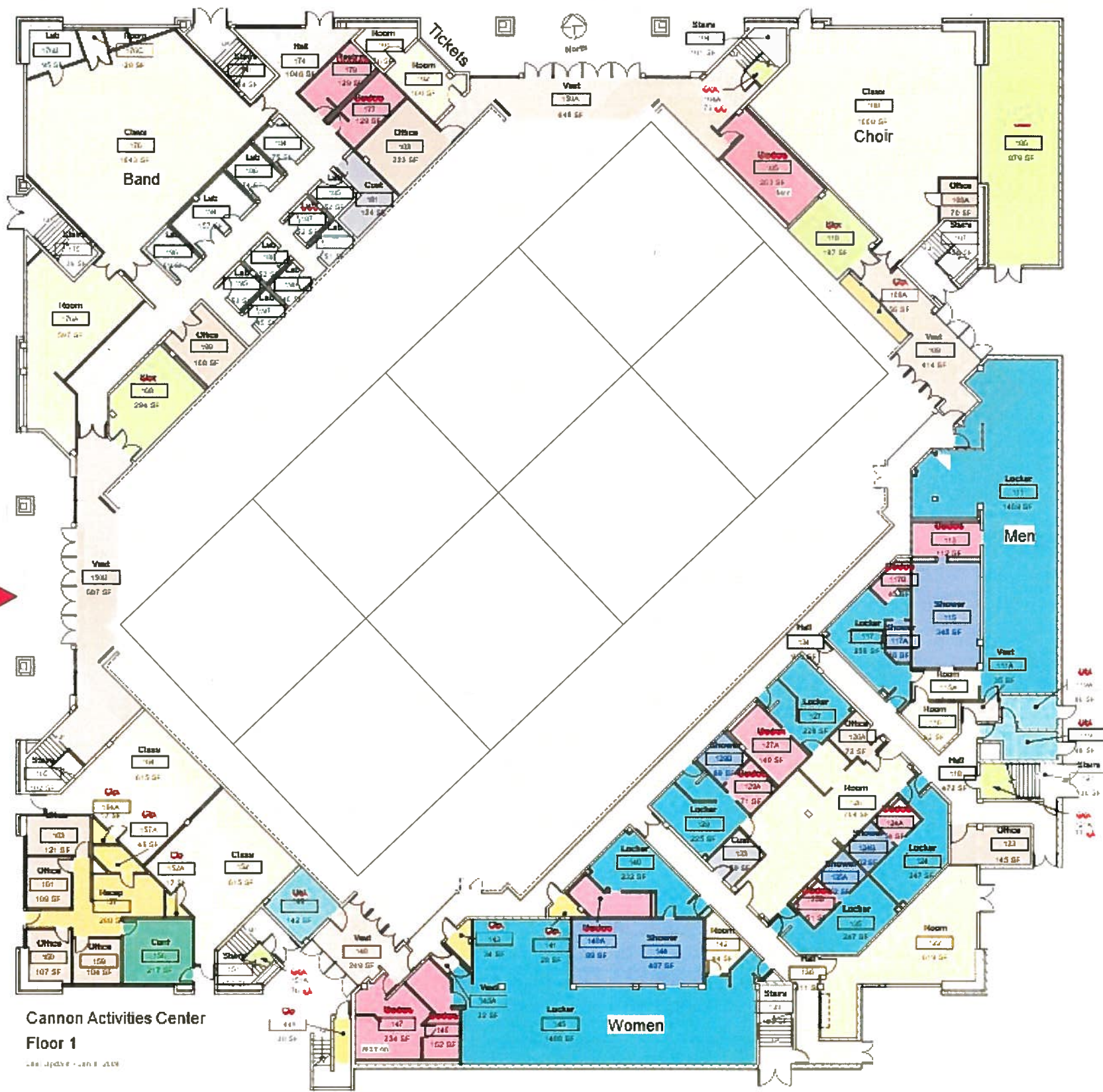

Cannon Activities Center  
Floor 1

1000 Update - 10/18/10





**2024 TEXACO WRESTLING STATE CHAMPIONSHIP**  
**OFFICIAL HHSAA TOURNAMENT ROSTER**

SCHOOL:

E-mail to: [roster@hhsaa.org](mailto:roster@hhsaa.org) / Deadline: 11:59 PM, Saturday, February 17, 2024

PRINT or TYPE last and first names of all WRESTLERS who are OFFICIALLY entered in the HHSAA tournament. Entries must be submitted by the respective leagues as specified in Paragraph IV of Tournament Information. Names listed below will be the official list for entry into the Blaisdell Arena. **DO NOT INSERT MORE THAN ONE NAME IS EACH SLOT.** If more than one name is listed, only one will be allowed entry. Coaches and Managers may be required to produce identification with photo for verification purposes. **Please note that only confirmed participants will be allowed entry without form. All other will be required to pay entry fee.**

NFHS Rule 4-5-5: When there are consecutive days of team competition, there shall be a 1-pound additional allowance granted each day for all wrestlers up to a maximum of two pounds.

***BOYS ENTRIES***

WT	PARTICIPANT	GRADE	ALTERNATE (Y/N)	LEAGUE SEED
106				
113				
120				
126				
132				
138				
145				
152				
160				
170				
182				
195				
220				
285				

***GIRLS ENTRIES***

WT	PARTICIPANT	GRADE	ALTERNATE (Y/N)	LEAGUE SEED
97				
102				
107				
112				
117				
122				
127				
132				
138				
145				
155				
168				
184				
225				

**HEAD COACH (cell#):** Boys:  Girls:   
**EMAIL:** Boys:  Girls:   
**ASSISTANT COACH:** \_\_\_\_\_  
**ASSISTANT COACH:** \_\_\_\_\_  
**ATHLETIC TRAINER:** \_\_\_\_\_  
**MANAGER:** \_\_\_\_\_

**ATHLETIC DIRECTOR'S SIGNATURE\*:** \_\_\_\_\_



**Hawaii High School Athletic Association**

- P.O. Box 11419 • HONOLULU, HAWAII 96828 •
- PHONE: (808) 800-4092
- www.sportshigh.com - info@hhsaa.org •

**2024 TEXACO / HHSAA WRESTLING  
SOUVENIR T-SHIRT PRE-ORDER FORM**

\_\_\_\_\_ School requests to order the following sizes of the souvenir Drifit T-shirts at \$20.00 per shirt.

Size	Quantity	Price	Total
Small		\$20.00	
Medium		\$20.00	
Large		\$20.00	
X-Large		\$20.00	
XX-Large		\$20.00	
		<b>GRAND TOTAL</b>	



Email preorders to your respective host (see below) school. Checks payable to HHSAA may be brought to the tournament site of teams first game. **Note: preorders must be paid in full by first day of the tournament or shirts will be released to the general public.**

**Ed Paola**  
Kamehameha Schools - Kapalama  
E-mail: edpaola@ksbe.edu

Contact person: \_\_\_\_\_

Daytime phone: \_\_\_\_\_

Email Address: \_\_\_\_\_

## HHSAA Wrestling State Tournament Records

**Year**      **Champion School**                      **Score**                      **League**                      **Coach**  
**1966**      **Kailua**    **90**    **OIA**    **Mario Valdestri**

Boys Winners

Weight	Name	School	Weight	Name	School
95 lbs	Fred Nazareth	Leilehua	145 lbs	Charles Wonder	Leilehua
103	Don Berglund	Radford	154	Doug Fox	Punahou
112	Warren Sabate	Kailua	165	Don Straton	Kailua
120	Walter Niino	Kaimuki	180	Polo Afuvai	Kahuku
127	Don Chalmers	Waianae	191	Ronald Noa	Kaimuki
133	Steve Christianson	Leilehua	210	Chuck Weise	Kailua
138	Dennis Bouregois	Kahuku	Unlimited	Greg Kila	Waianae

**Year**      **Champion School**                      **Score**                      **League**                      **Coach**  
**1967**      **Punahou**    **78**    **ILH**    **Skip Pennington**

Boys Winners

Weight	Name	School	Weight	Name	School
95 lbs	Lionel Kaiura	Kaimuki	145 lbs	Wendell Tengan	Kaimuki
103	Arthur Rego	Waianae	154	Kirk Oakley	Kailua
112	Manuel Harris	Kamehameha	165	Vego Moeai	Kahuku
120	Wesley Oh	Iolani	180	John Aoki	Kaimuki
127	John Bain	Radford	191	Polo Afuvai	Kahuku
133	Don Chalmers	Waianae	210	Gil Scott	Punahou
138	Russell Ahuna	Kamehameha	Unlimited	Don Muraco	Punahou

**Year**      **Champion School**                      **Score**                      **League**                      **Coach**  
**1968**      **Punahou**    **78**    **ILH**    **Skip Pennington**

Boys Winners

Weight	Name	School	Weight	Name	School
95 lbs	Tatsuhiko Hikiji	Kaimuki	145 lbs	Lowrey Power	Punahou
103	David Abe	Kahuku	154	Wayne Sadoyama	Iolani
112	Fred Nazareth	Leilehua	165	Paul Reppun	Punahou
120	Dick Loomis	Punahou	180	Dave Lundquist	Punahou
127	Mel Steers	Kailua	191	Drew Braun	Punahou
133	Pat Chalmers	Waianae	210	Bill Puluti	McKinley
138	Earl Anduha	Waianae	Unlimited	Greg Kila	Waianae

**Year**      **Champion School**                      **Score**                      **League**                      **Coach**  
**1969**      **Kahuku**    **58**    **OIA**    **Gil Hatter**

Boys Winners

Weight	Name	School	Weight	Name	School
98 lbs	Tatsuhiko Hikiji	Kaimuki	145 lbs	Earl Anduha	Waianae
103	David Abe	Kahuku	154	Kurtis Saiki	Lahainaluna
112	Phil Smith	Baldwin	165	Tuinanau Ala	Waianae
120	Scott Power	Punahou	180	Ben Au	Kahuku
127	Gary Hutchinson	Kailua	200	Scott Haneberg	Punahou
133	Terry Harris	Campbell	Unlimited	James Sullivan	McKinley
138	Eugene Yogi	Kailua			

## HHSAA Wrestling State Tournament Records

**Year**      **Champion School**                      **Score**                      **League**                      **Coach**  
**1970**      **Kaimuki**    **80**    **ILH**    **Peter Goo**

Boys Winners

<u>Weight</u>	<u>Name</u>	<u>School</u>	<u>Weight</u>	<u>Name</u>	<u>School</u>
98 lbs	Guy Oshiro	Mau	138 lbs	Doug Straehley	Punahou
103	Stanford Teruya	Kaimuki	145	Ray Mulhern	Radford
112	Tatsuhiko Hikiji	Kaimuki	154	Ralph Migita	Waialua
120	Bill Binz	Kahuku	165	George Lindsey	St. Louis
127	Dale Tengan	Kaimuki	180	Tuinanau Ala	Waianae
133	Alfred Torres	St. Louis	200	Blessing Bird	McKinley
			Unlimited	Scott Haneberg	Punahou

---

**Year**      **Champion School**                      **Score**                      **League**                      **Coach**  
**1971**      **Radford**    **91**    **OIA**    **Bob Frey**

Boys Winners

<u>Weight</u>	<u>Name</u>	<u>School</u>	<u>Weight</u>	<u>Name</u>	<u>School</u>
98 lbs	James Camit	Kahuku	138 lbs	Craig Smith	Punahou
105	Willy Lum	Punahou	145	Tom Hugo	Kamehameha
112	Stanford Teruya	Kaimuki	155	Ray Mulhern	Radford
119	George Sutton	Punahou	167	Rudy Gabrillo	Radford
126	Kevin Ida	Kaimuki	185	Tuinanau Ala	Waianae
132	Manfred Ng	Waianae	200	Roger Hefferman	Kahuku
			Unlimited	Wesley Goodin	Mau

---

**Year**      **Champion School**                      **Score**                      **League**                      **Coach**  
**1972**      **St. Louis**    **70**    **ILH**    **James Dainty**

Boys Winners

<u>Weight</u>	<u>Name</u>	<u>School</u>	<u>Weight</u>	<u>Name</u>	<u>School</u>
98 lbs	Jeff Nakama	Baldwin	138 lbs	David Badeaux	Kailua
105	Ranier Bicoy	Radford	145	Vince Smith	Waipahu
112	Milton Yasunaga	Farrington	155	Doug Berliner	Radford
119	Dave Schaeffer	Punahou	167	Tom Shiroma	St. Louis
126	Craig Yamaguchi	Waipahu	185	Saipele Manutai	Kahuku
132	Nathan Harris	Campbell	200	Tiloi Lolotai	Iolani
			Unlimited	Chester Shinsato	Farrington

---

**Year**      **Champion School**                      **Score**                      **League**                      **Coach**  
**1973**      **St. Louis**    **74**    **ILH**    **James Dainty**

Boys Winners

<u>Weight</u>	<u>Name</u>	<u>School</u>	<u>Weight</u>	<u>Name</u>	<u>School</u>
98 lbs	Leigh Tonai	Baldwin	138 lbs	Kelly Smith	Waipahu
105	Gary Jay	Kamehameha	145	Grant Nakamoto	Baldwin
112	Robert Motooka	Lahainaluna	155	Paul Devos	Kalani
119	Milton Yasunaga	Farrington	167	Randy Lee	St. Louis
126	Noran Fujino	Konawaena	185	John Kalama	Kailua
132	Craig Yamaguchi	Waipahu	200	Tiloi Lolotai	Iolani
			Unlimited	Mike Cho	Waipahu

## HHSAA Wrestling State Tournament Records

**Year**      **Champion School**                      **Score**                      **League**                      **Coach**  
**1974**      **Radford**    **106 1/2**                      **OIA**    **Bob Frey**

Boys Winners

<u>Weight</u>	<u>Name</u>	<u>School</u>	<u>Weight</u>	<u>Name</u>	<u>School</u>
98 lbs	David Miyashiro	Castle	138 lbs	David Dawson	Radford
105	Leigh Tonai	Baldwin	145	Jake Kawamata	Waialua
112	Steve Canne	Radford	155	Jay Onasch	Iolani
119	Robert Motooka	Lahainaluna	167	Mike Fullum	Radford
126	Roy Johns	Radford	185	Alvin Tanaka	St. Louis
132	Greg Fronczak	St. Louis	200	Alo Faleafine	Radford
			Unlimited	Harris Matsushima	St. Louis

---

**Year**      **Champion School**                      **Score**                      **League**                      **Coach**  
**1975**      **Radford**    **96**    **OIA**    **Bob Frey**

Boys Winners

<u>Weight</u>	<u>Name</u>	<u>School</u>	<u>Weight</u>	<u>Name</u>	<u>School</u>
98 lbs	Matthew Ha	Lahainaluna	138 lbs	Dave Dawson	Radford
105	Craig Katsuda	Kaimuki	145	Glen Nagata	Kalani
112	Leigh Tonai	Baldwin	155	John Lino	Radford
119	Steve Canne	Radford	167	Henry Wassman	St. Louis
126	Hector Cintron	Radford	185	Ed Caldeira	Kailua
132	Barry Kobata	Kaiser	200	Casey Kunitomo	Kamehameha
			Unlimited	Chet Rabusite	Baldwin

---

**Year**      **Champion School**                      **Score**                      **League**                      **Coach**  
**1976**      **Radford**    **205 1/3**                      **OIA**    **Wayne Ohashi/Bob Frey**

Boys Winners

<u>Weight</u>	<u>Name</u>	<u>School</u>	<u>Weight</u>	<u>Name</u>	<u>School</u>
98 lbs	Dennis Bentosino	St. Louis	138 lbs	Bryan Lindsey	St. Louis
105	Glenn Fujimoto	St. Louis	145	Ernest Santiago	Waipahu
112	Mike Miyamoto	Lahainaluna	155	Rick Rullum	Radford
119	Cory Gima	Radford	167	John Lino	Radford
126	Matthew Mark	Waialua	185	John Leupp	Radford
132	Ken Oishi	Punahou	200	Nolan Baker	Waialua
			Unlimited	Willie Kamakana	Punahou

---

**Year**      **Champion School**                      **Score**                      **League**                      **Coach**  
**1977**      **Radford**    **224**    **OIA**    **Bob Frey**

Boys Winners

<u>Weight</u>	<u>Name</u>	<u>School</u>	<u>Weight</u>	<u>Name</u>	<u>School</u>
98 lbs	Duane Bicoy	Leilehua	138 lbs	John Piper	Campbell
105	Neal Tamashiro	Kalani	145	Dongku Yom	Radford
112	Nelson Nomura	Kalani	155	Niall Yamane	Punahou
119	Douglas Sparks	Radford	167	Wendell Wong	Baldwin
126	Cory Gima	Radford	185	Steve Robello	Kamehameha
132	Matthew Mark	Waialua	200	Nolan Baker	Waialua
			Unlimited	Willie Kamakana	Punahou

## HHSAA Wrestling State Tournament Records

**Year**      **Champion School**                      **Score**                      **League**                      **Coach**  
**1978**      **Kaiser**    **193 1/2**                      **OIA**    **Stephen Kim**

Boys Winners

<u>Weight</u>	<u>Name</u>	<u>School</u>	<u>Weight</u>	<u>Name</u>	<u>School</u>
98 lbs	Eric Kaneshiro	Campbell	138 lbs	Solomon Lee	Mau
105	Scott Heston	Radford	145	Stan Delapp	Radford
112	Alex Sonson	Waipahu	155	Larry Remillard	Punahou
119	Andrew Louis	Ka'u	167	Derrick Kaneshiro	Kaiser
126	Kent Walrack	Punahou	185	Steve Chun	Punahou
132	Duane Agena	Kaiser	200	Mack Thacker	Punahou
			Unlimited	Willie Kamakana	Kaiser

**Year**      **Champion School**                      **Score**                      **League**                      **Coach**  
**1979**      **Kaiser**    **163 1/2**                      **OIA**    **Stephen Kim**

Boys Winners

<u>Weight</u>	<u>Name</u>	<u>School</u>	<u>Weight</u>	<u>Name</u>	<u>School</u>
98 lbs	Harrison Hayashi	McKinley	138 lbs	Duane Agena	Kaiser
105	Anthony Calvin	Moanalua	145	Frank Omura	Iolani
112	Brian Muranaka	Kaiser	155	Tom Mullen	Punahou
119	Andrew Oishi	Kaimuki	167	Spencer Mello	Kamehameha
126	Alan Abangan	Leilehua	185	Richard Mello	Kamehameha
132	Douglas Sparks	Radford	200	Buddy Evans	Farrington
			Unlimited	Kenneth Smith	Kahuku

**Year**      **Champion School**                      **Score**                      **League**                      **Coach**  
**1980**      **Radford**    **162 1/2**                      **OIA**    **Wayne Ohashi**

Boys Winners

<u>Weight</u>	<u>Name</u>	<u>School</u>	<u>Weight</u>	<u>Name</u>	<u>School</u>
98 lbs	Joji Takemoto	Kaiser	138 lbs	Mike Hegland	Kaiser
105	Mike Kim	Kaiser	145	Trevor Hugo	Kamehameha
112	Anthony Calvin	Moanalua	155	Paul Chang	Kamehameha
119	Earl Kim	Iolani	167	Tom Mullen	Punahou
126	Alan Abangan	Leilehua	185	Spencer Mello	Kamehameha
132	Furl Kamakaala	Kahuku	200	Jack Sims	Radford
			Unlimited	Kenneth Smith	Kahuku

**Year**      **Champion School**                      **Score**                      **League**                      **Coach**  
**1981**      **Kaiser**    **180 1/2**                      **OIA**    **Stephen Kim**

Boys Winners

<u>Weight</u>	<u>Name</u>	<u>School</u>	<u>Weight</u>	<u>Name</u>	<u>School</u>
98 lbs	Martin Muranaka	Kalani	138 lbs	Henry Chapman	Kamehameha
105	Joji Takemoto	Kaiser	145	Richard Arnold	Radford
112	Dane Kaneshiro	Kaiser	155	John LaPenes	Kahuku
119	Kevin Asano	Pearl City	167	Mark Kalilikane	Pearl City
126	Yoshi Honda	Radford	185	David Stant	Kahuku
132	Neal Murakami	Kaiser	200	Bernard Lakemaker	Iolani
			Unlimited	Kimo Aalona	Kahuku

## HHSAA Wrestling State Tournament Records

**Year**      **Champion School**                      **Score**                      **League**                      **Coach**  
**1982**      **Kaiser**    **189 1/2**                      **OIA**    **Stephen Kim**

Boysl Winners

<u>Weight</u>	<u>Name</u>	<u>School</u>	<u>Weight</u>	<u>Name</u>	<u>School</u>
98 lbs	Bernard Au	Hilo	138 lbs	Joe Rodrigues	Kaiser
105	Calvin Matutino	Waianae	145	Darren Egami	Punahou
112	Arnold Abangan	Leilehua	155	Hubert Pruett	Waiakea
119	Jim Takatsuka	Punahou	167	Howard Ahia	Kaiser
126	Yoshi Honda	Radford	185	Clayton Smith	Kailua
132	Ron Arnold	Radford	200	Felix Pada	St. Louis
			Unlimited	Sione Pulotu	Kahuku

**Year**      **Champion School**                      **Score**                      **League**                      **Coach**  
**1983**      **Kahuku**    **159 1/2**                      **OIA**    **Lester Souza**

Boys Winners

<u>Weight</u>	<u>Name</u>	<u>School</u>	<u>Weight</u>	<u>Name</u>	<u>School</u>
98 lbs	Kale Flagg	Iolani	138 lbs	Yoshi Honda	Radford
105	Patrick Higa	Iolani	145	Mike Giffen	Radford
112	Clark Pantil	Radford	155	Jeff Hong	Kaiser
119	Calvin Matutino	Waianae	167	Lance Stevens	Lahainaluna
126	Darryl Terukina	Campbell	185	Howie Klemmer	Punahou
132	Jerry Yi	Leilehua	200	Everest Aalona	Kahuku
			Unlimited	Sione Pulotu	Kahuku

**Year**      **Champion School**                      **Score**                      **League**                      **Coach**  
**1984**      **Iolani**    **159 1/2**                      **ILH**    **Carl Schroers**

Boys Winners

<u>Weight</u>	<u>Name</u>	<u>School</u>	<u>Weight</u>	<u>Name</u>	<u>School</u>
98 lbs	Dennis Fernando	Moanalua	138 lbs	Darryl Terukina	Campbell
105	Patrick Higa	Iolani	145	Jerry Yi	Leilehua
112	Kale Flagg	Iolani	155	Arn Van Dyke	Punahou
119	Ben Terukina	Campbell	167	Paul Hamilton	Roosevelt
126	Tim Ng	Leilehua	185	Mark Spoons	Iolani
132	Jeff Fancher	Punahou	200	Tory Winward	Kaiser
			Unlimited	Bern Brostek	Iolani

**Year**      **Champion School**                      **Score**                      **League**                      **Coach**  
**1985**      **Kahuku**    **174 1/2**                      **OIA**    **Lester Souza**

Individual Winners

<u>Weight</u>	<u>Name</u>	<u>School</u>	<u>Weight</u>	<u>Name</u>	<u>School</u>
98 lbs	Colin Minami	Kaiser	138 lbs	Marc Moneymaker	Kaiser
105	Dennis Fernando	Moanalua	145	Keith Higa	Mililani
112	Pat Higa	Iolani	155	Jimmie Swann	Nanakuli
119	Kale Flagg	Iolani	167	Mike Juenzil	Kamehameha
126	Dane Kamakaala	Kahuku	185	Stanley Good	Campbell
132	Ben Terukina	Campbell	200	Allen Smith	Kailua
			Unlimited	Talbert Lam Ho	Waiakea

## HHSAA Wrestling State Tournament Records

<b><u>Year</u></b>	<b><u>Champion School</u></b>	<b><u>Score</u></b>	<b><u>League</u></b>	<b><u>Coach</u></b>
1986	Iolani	162 1/2	ILH	Carl Schroers

Individual Winners

Weight	Name	School	Weight	Name	School
98 lbs	Myong Freestone	Moanalua	138 lbs	Guy Mitsunaga	Moanalua
105	Colin Minami	Kaiser	145	Kevin Allen	Punahou
112	J. B. Gallarde	Moanalua	155	David Paaluki	Waianae
119	Patrick Higa	Iolani	167	Stanley Good	Campbell
126	Jim Johnson	Punahou	185	Dwight Doane	Waipahu
132	Ben Terukina	Campbell	200	Charlton Moananu	Waianae
			Unlimited	Talbert Lam Ho	Waiakea

<b><u>Year</u></b>	<b><u>Champion School</u></b>	<b><u>Score</u></b>	<b><u>League</u></b>	<b><u>Coach</u></b>
1987	Waianae	151	OIA	James Sequin

Boys Winners

Weight	Name	School	Weight	Name	School
98 lbs	Kevin Bellefeuille	St. Louis	138 lbs	Lawrence Lee	St. Louis
105	Randy Florendo	Waianae	142	Joe Yuilin	Waianae
112	Ryan Yokoyama	Kaiser	155	Jacob Garcia	Punahou
119	Billy Venenciano	Molokai	167	David Larsen	Kaiser
126	Bradley Rutt	Pearl City	185	Carlton Moananu	Waianae
132	Jon Sekiya	Punahou	200	Keoni Fontanilla	Hana
			275	William Molina	Waianae

<b><u>Year</u></b>	<b><u>Champion School</u></b>	<b><u>Score</u></b>	<b><u>League</u></b>	<b><u>Coach</u></b>
1988	Iolani	143	ILH	Carl Schroers

Boys Winners

Weight	Name	School	Weight	Name	School
98 lbs	Jon Miyashiro	McKinley	138 lbs	Ryan Sugai	MPI
105	Merrick Nishimoto	Konawaena	145	Lawrence Lee	St. Louis
112	Kevin Bellefeuille	St. Louis	155	Bill Stonebreaker	Kaiser
119	Billy Venenciano	Molokai	167	Jacob Garcia	Punahou
126	Michael Taniguchi	Iolani	185	John Correa	St. Louis
132	Guy Inoue	Moanalua	200	David Good	Campbell
			275	John Feinga	Kahuku

<b><u>Year</u></b>	<b><u>Champion School</u></b>	<b><u>Score</u></b>	<b><u>League</u></b>	<b><u>Coach</u></b>
1989	Iolani	163	ILH	Carl Schroers

Boys Winners

Weight	Name	School	Weight	Name	School
103 lbs	Joe Miller	Baldwin	140 lbs	Cole Weaver	Moanalua
112	Travis Araki	St. Louis	145	Mark Stephens	Radford
119	Kevin Bellefeuille	St. Louis	152	Lawrence Lee	St. Louis
125	Benny Veneciano	Molokai	160	Dean Larsen	Kailua
130	Mike Taniguchi	Iolani	171	Bill Stonebreaker	Kaiser
135	Joe Baregi	Waialua	189	Warren Mamizuka	Kahuku
			275	Fred Liva	McKinley



## HHSAA Wrestling State Tournament Records

**Year**      **Champion School**                      **Score**                      **League**                      **Coach**  
**1990**      **Iolani**    **184.5**                      **ILH**                                      **Todd Los Banos**

Boys Winners

Weight	Name	School	Weight	Name	School
103 lbs	Scott Kaneshiro	Roosevelt	140 lbs	Avin Phillip	Kahuku
112	Joe Miller	Baldwin	145	Travis Stephenson	Konawaena
119	Travis Araki	St. Louis	152	Frank Pascua	Aiea
125	Jamie Dixon	Pearl City	160	John Flavin	Baldwin
130	Kendrick Kakazu	Punahou	171	Sean Satterfield	Punahou
135	Ryan Hoopii	Iolani	189	Todd Shibata	Iolani
			275	Stephen Vierra	Kahuku

**Year**      **Champion School**                      **Score**                      **League**                      **Coach**  
**1991**      **Iolani**    **222.5**                      **ILH**                                      **Carl Schroers**

Boys Winners

Weight	Name	School	Weight	Name	School
103 lbs	Aaron Pahk	Kahuku	140 lbs	Mike Shin	Iolani
112	Rod Kam	McKinley	145	Avin Phillip	Kahuku
119	Jeff Rutt	Pearl City	152	Len Higashi	Iolani
125	Paul Matsumoto	Iolani	160	James Morimoto	Baldwin
130	Kendrick Kakazu	Punahou	171	Kena Heffernan	Punahou
135	Ryan Hoopii	Iolani	189	Simeon Vierra	Kahuku
			275	Stephen Vierra	Kahuku

**Year**      **Champion School**                      **Score**                      **League**                      **Coach**  
**1992**      **Iolani**    **167.5**                      **ILH**                                      **Carl Schroers**

Boys Winners

Weight	Name	School	Weight	Name	School
103 lbs	Oudom Phoutaseng	Kaimuki	140 lbs	Joshua Benkman	Kahuku
112	William Landford	Waianae	145	Dennis Fujii	Moanalua
119	Rod Kam	McKinley	152	Alan Ikeda	McKinley
125	Ryan Nishimoto	Mililani	160	Aukai Pruett	Moanalua
130	Kennison Lee	Mid-Pacific	171	Kena Heffernan	Punahou
135	Brennan Kamaka	Waipahu	189	Carl Bryson	Hawaii Prep
			275	Simeon Vierra	Kahuku

**Year**      **Champion School**                      **Score**                      **League**                      **Coach**  
**1993**      **Iolani**    **176.5**                      **ILH**                                      **Carl Schroers**

Boys Winners

Weight	Name	School	Weight	Name	School
103 lbs	Stuart Hotema	Maui	140 lbs	Jason Fernandez	Maui
112	Neil Takahashi	Mid-Pacific	145	Bryan Lee	Iolani
119	William Landford	Waianae	152	Carlton Okamoto	Baldwin
125	Steven Sigafus	Kalaheo	160	Aukai Pruett	Moanalua
130	Brad Takenaka	Iolani	171	Ken Makaiau	Kahuku
135	Glenn Agunat	Kamehameha	189	Kirby Yoshida	Iolani
			275	Maunakea Mossman	Kaimuki

## HHSAA Wrestling State Tournament Records

<b><u>Year</u></b>	<b><u>Champion School</u></b>	<b><u>Score</u></b>	<b><u>League</u></b>	<b><u>Coach</u></b>
1994	Iolani	178.5	ILH	Carl Schroers

Boys Winners

Weight	Name	School	Weight	Name	School
103 lbs	Rey Duazo	Waipahu	140 lbs	Kyle Mericle	Waianae
112	Neil Takahashi	Mid-Pacific	145	Traione Trout	McKinley
119	Alex Hwang	Kaimuki	152	Carlton Okamoto	Baldwin
125	Rico Ventenilla	Konawaena	160	Dan Nishita	Iolani
130	Gerald Canaday	Kahuku	171	Stephen Lucas	Lahainaluna
135	Brad Takenaka	Iolani	189	Kirby Yoshida	Iolani
			275	Maunakea Mossman	Kaimuki

<b><u>Year</u></b>	<b><u>Champion School</u></b>	<b><u>Score</u></b>	<b><u>League</u></b>	<b><u>Coach</u></b>
1995	Leilehua	131.5	OIA	Stan Ono

Boys Winners

Weight	Name	School	Weight	Name	School
100 lbs	Ryan Sugihara	Mid-Pacific	142 lbs	Rico Ventenilla	Konawaena
106	Russell Ventenilla	Konawaena	151	Eddie Kealoha	St. Louis
112	Charles Kimoto	Hilo	160	David Wallace	Kahuku
119	Justin Orian	Kamehameha	172	Patrick Andreshak	Moanalua
126	Brendon Takara	Kaimuki	185	Shane Dacuycuy	Kahuku
134	Ryan Cabinian	Leilehua	215	Jimmy Betham	Kahuku
			275	Kevin Kim	Leilehua

<b><u>Year</u></b>	<b><u>Champion School</u></b>	<b><u>Score</u></b>	<b><u>League</u></b>	<b><u>Coach</u></b>
1996	Iolani	122.5	ILH	Carl Schroers

Boys Winners

Weight	Name	School	Weight	Name	School
103 lbs	Kahaa Rezantes	Kamehameha	145 lbs	John Canaday	Kahuku
112	Craig Shinsato	Moanalua	152	Sam Lawn	Iolani
119	Peter Matsumoto	Mid-Pacific	160	Eddie Kealoha	St. Louis
125	Loren Otake	Iolani	171	Tevita Tuikolongahau	Waipahu
130	Chris Nguyen	Lahainaluna	189	Dan Davis	Kalaheo
135	Lewis Lagmay	Leilehua	215	Billy Prince	Hawaii Prep
140	Spencer Sequin	St. Louis	275	Shawn Ball	Punahou

<b><u>Year</u></b>	<b><u>Champion School</u></b>	<b><u>Score</u></b>	<b><u>League</u></b>	<b><u>Coach</u></b>
1997	Kamehameha	176	ILH	AI Chee

Boys Winners

Weight	Name	School	Weight	Name	School
103 lbs	Ryson Nakamasu	Moanalua	145	Spencer Sequin	St. Louis
112	Russell Ventenilla	Konawaena	152	Keola Kalama	McKinley
119	Craig Shinsato	Moanalua	160	Imi Richardson	McKinley
125	Troy Fujiyama	McKinley	171	Joe Chaves	Kamehameha
130	Clinton Babayan	Lahainaluna	189	Geste Ornellas	St. Louis
135	Matt Landford	Waianae	215	Hector Jalamo	Kalaheo
140	Jason Brown	Iolani	275	Steven Grace	Kamehameha

## HHSAA Wrestling State Tournament Records

<u>Year</u>	<u>Champion School</u>	<u>Score</u>	<u>League</u>	<u>Coach</u>
<b>1998</b>	<b>(boys) Kamehameha (girls) McKinley</b>	<b>149.0 136.0</b>	<b>ILH OIA</b>	<b>Al Chee Chris Johnson</b>

Boys Individual Winners

Weight	Name	School	Weight	Name	School
103 lbs	Kamal Pfieffe	Maui	145	Spencer Sequin	St. Louis
112	Joey Bareng	Moanalua	152	Ethan Taomae	Iolani
119	Byrd Uyeda	Roosevelt	160	Poai Sukanuma	Waiakea
125	Sean Collins	Radford	171	Gerald Welch	St. Louis
130	Ashley Byrd	Kamehameha	189	Ve'a Tupou	Kahuku
135	Edwin Acopan	McKinley	215	Joshua Ka'akua	Punahou
140	Richard Kamakahi	Leilehua	275	Chris Vincent	Castle

Girls Individual Winners

Weight	Name	School	Weight	Name	School
98 lbs	Clarissa Chun	Roosevelt	140	Lia Berger	Lahainaluna
103	Shelley Tomita	Moanalua	155	Lauwae Smith	Radford
108	Katie Kunimoto	Castle	175	Kahea Myers	Leilehua
114	Jill Remiticado	Iolani	220	Donnell Bradley	Radford
121	Renee Nakata	Moanalua			
130	Val Busch	Waiakea			

<u>Year</u>	<u>Champion School</u>	<u>Score</u>	<u>League</u>	<u>Coach</u>
<b>1999</b>	<b>(boys) Kamehameha (girls) Moanalua</b>	<b>178.0 95.0</b>	<b>ILH OIA</b>	<b>Palani Williams Joel Kawachi</b>

Boys Individual Winners

Weight	Name	School	Weight	Name	School
103 lbs	Richard Fujiyama	McKinley	145	Kamaka Jingao	Kamehameha
112	Travis Lee	St. Louis	152	Kawika Casco	Lahainaluna
119	Ken Kakesako	Iolani	160	John Rosa	Kamehameha
125	Justin Hussey	Kamehameha	171	Richard Robles Jr.	Kamehameha
130	Taylor Tanaka	Iolani	189	Jordan Orian	Kamehameha
135	Sean Collins	Radford	215	Saia Lotulelei	Maui
140	Mark Grammer	Castle	275	David Kapalolu	Kamehameha

Girls Individual Winners

Weight	Name	School	Weight	Name	School
98 lbs	Clarissa Chun	Roosevelt	130	Val Busch	Waiakea
103	Danelle Miyamoto	Hawaii Baptist	140	Emery Sagucio	Hilo
108	Shelly Ann Tomita	Moanalua	155	Aloha Chaves	Radford
114	Ausha San Nicholas	Pearl City	175	Malama Sylve	Leilehua
121	Heather Robertson	Radford	220	Donnell Bradley	Radford

## HHSAA Wrestling State Tournament Records

<b><u>Year</u></b>	<b><u>Champion School</u></b>	<b><u>Score</u></b>	<b><u>League</u></b>	<b><u>Coach</u></b>
2000	(boys) Iolani (girls) Moanalua	204.0 143.5	ILH OIA	Carl Schroers Joel Kawachi

Boys Individual Winners

<u>Weight</u>	<u>Name</u>	<u>School</u>	<u>Weight</u>	<u>Name</u>	<u>School</u>
103 lbs	Troy Takahashi	St. Louis	145	Nick Muraoka	Iolani
112	Kareem Pfeifle	Maui	152	Jansen Fukuda	Mid-Pacific
119	Travis Lee	St. Louis	160	Isaac Rodrigues	St. Louis
125	Ken Kakesako	Iolani	171	Kawika Casco	Lahainaluna
130	Travis Takahashi	St. Louis	189	Gerald Welch	St. Louis
135	Jonathan Spiker	St. Louis	215	Douglas Hiu	Kahuku
140	Taylor Takata	Iolani	275	Saia Lotulelei	Maui

Girls Individual Winners

<u>Weight</u>	<u>Name</u>	<u>School</u>	<u>Weight</u>	<u>Name</u>	<u>School</u>
98 lbs	Whitney Rabacal	Roosevelt	130	Shani Alvarado	Mililani
103	Melissa Orden	McKinley	140	Stephany Lee	Moanalua
108	Caylene Valdez	Moanalua	155	Ashley Gaspar	Nanakuli
114	Carrie Nishimura	McKinley	175	Iwalani Fonoimoana	Kamehameha
121	Cathy Migita	Castle	220	Malama Sylve	Leilehua

<b><u>Year</u></b>	<b><u>Champion School</u></b>	<b><u>Score</u></b>	<b><u>League</u></b>	<b><u>Coach</u></b>
2001	(boys) St. Louis (girls) Moanalua	207.5 134.5	ILH OIA	Todd Los Banos Joel Kawachi

Boys Individual Winners

<u>Weight</u>	<u>Name</u>	<u>School</u>	<u>Weight</u>	<u>Name</u>	<u>School</u>
103 lbs	Daniel Furuto	Punahou	145	Jonathan Spiker	St. Louis
112	Kris Wong	Iolani	152	Kainoa Casco	Lahainaluna
119	Troy Takahashi	St. Louis	160	Jansen Fukuda	Mid Pacific
125	Grant Nakamura	Baldwin	171	Mark Egesdal	Punahou
130	Travis Lee	St. Louis	189	Carden Vincent	Kamehameha
135	Jake Kamaka'ala	Kahuku	215	Prince Brown	St. Louis
140	Charles Peabody	St. Louis	275	Saia Lotulelei	Maui

Girls Individual Winners

<u>Weight</u>	<u>Name</u>	<u>School</u>	<u>Weight</u>	<u>Name</u>	<u>School</u>
98 lbs	Tanya Miyasaki	Castle	130	Dara Ching	Pearl City
103	Melissa Orden	McKinley	140	Stephany Lee	Moanalua
108	Caylene Valdez	Moanalua	155	Ashley Gaspar	Nanakuli
114	DeAnna Lau	Punahou	175	Gabrielle Nicholas	Moanalua
121	Cathy Migita	Castle	220	Iwalani Fonoimoana	Kamehameha

## HHSAA Wrestling State Tournament Records

<b><u>Year</u></b>	<b><u>Champion School</u></b>	<b><u>Score</u></b>	<b><u>League</u></b>	<b><u>Coach</u></b>
2002	(boys) St. Louis (girls) Kahuku	154.5 151	ILH OIA	Todd Los Banos Reggie Torres

Boys Individual Winners

Weight	Name	School	Weight	Name	School
103 lbs	Shane Rellez	Hilo	145	Jonathan Spiker	St. Louis
112	Ben Wilmore	St. Louis	152	Jeffrey Larita	Lahainaluna
119	Jared Wakayama	Iolani	160	Kainoa Casco	Lahainaluna
125	Brent Kakesako	Iolani	171	Robert Yamashita	Iolani
130	Justin Kawamata	Mililani	189	Riley Schmidtke	Mid Pacific
135	Rene Suehiro	McKinley	215	Justin Luafalemana	Molokai
140	Jamie Keehu	Mililani	275	Maele Uele	Waipahu

Girls Individual Winners

Weight	Name	School	Weight	Name	School
98 lbs	Justine Swafford	Kahuku	130	Jennifer Miyahira	Mid Pacific
103	Melissa Orden	McKinley	140	Shani Alvarado	Moanalua
108	Caylene Valdez	Moanalua	155	Stephany Lee	Moanalua
114	Debbi Sakai	Mililani	175	Ashley Gaspar	Nanakuli
121	Danyelle Hedin	Kailua	220	Iwalani Fonoimoana	Kamehameha

<b><u>Year</u></b>	<b><u>Champion School</u></b>	<b><u>Score</u></b>	<b><u>League</u></b>	<b><u>Coach</u></b>
2003	(boys) Iolani (girls) Kahuku	180.50 147.50	ILH OIA	Yoshi Honda Reggie Torres

Boys Individual Winners

Weight	Name	School	Weight	Name	School
103 lbs	Aaron Ishikawa	Iolani	145	Kyle Muraoka	Iolani
112	Brandon Low	St. Louis	152	Jonathan Spiker	St. Louis
119	Kodi Shepley	Baldwin	160	Mike Wheeler	King Kekaulike
125	Jared Wakayama	Iolani	171	Judd Vincent	Kamehameha
130	Ben Wilmore	St. Louis	189	Patrick Stachel	Kamehameha
135	Owen Yonehara	Iolani	215	Vincent Scott	St. Louis
140	Rene Suehiro	McKinley	275	Rory Jones	Leilehua

Girls Individual Winners

Weight	Name	School	Weight	Name	School
98 lbs	Angelee Homma	Aiea	130	Jasmine Norman	Kealakehe
103	Sadie Kaneda	Roosevelt	140	Kehau Kamauoha	Kahuku
108	Elizabeth Torres	Kahuku	155	Selina Perez	Baldwin
114	Caylene Valdez	Moanalua	175	Laosamoa Misa-Uli	Farrington
121	Danyelle Hedin	Kailua	220	Chasity Molina	Waianae

## HHSAA Wrestling State Tournament Records

<u>Year</u>	<u>Champion School</u>	<u>Score</u>	<u>League</u>	<u>Coach</u>
<b>2004</b>	<b>(boys) Kahuku</b> <b>(girls) Farrington</b>	<b>172.50</b> <b>153.50</b>	<b>OIA</b> <b>OIA</b>	<b>Reggie Torres</b> <b>Sanford Obra</b>

### Boys Individual Winners

Weight	Name	School	Weight	Name	School
103 lbs	Joshua Plechaty	Punahou	152	Kyle Muraoka	Iolani
112	Ikaika Medeiros	Hana	160	Adam Ah Sue	Kahuku
119	Brandon Low	St. Louis	171	Jared Silva	St. Louis
125	Daniel Morita	Kahuku	189	Jeff Antolin	Waipahu
130	Shane Vasconcellos	Kamehameha	140	Johanson Quist	Hilo
135	Alex Molina	Kealakehe	215	Dylan Rush	Konawaena
145	Nahe Akoi	Lahainaluna	275	Riley Martin	Iolani

### Girls Individual Winners

Weight	Name	School	Weight	Name	School
98 lbs	Carla Watase	Iolani	125	Danyelle Hedin	Kailua
103	Joleen Oshiro	Iolani	130	Krystal Kiyuna	Aiea
108	Sadie Kaneda	Roosevelt	140	Chaneal Meletia	Hawaii Baptist
114	Tamatha Hufana	Farrington	155	Delijah Joung	Waipahu
120	Candice Coratibo	Baldwin	175	Laosamoa Misa-Uli	Farrington
			220	Randolyn Nohara	Kamehameha

<u>Year</u>	<u>Champion School</u>	<u>Score</u>	<u>League</u>	<u>Coach</u>
<b>2005</b>	<b>(boys) Kamehameha-Kapalama</b> <b>(girls) Iolani</b>	<b>128.5</b> <b>130.5</b>	<b>ILH</b> <b>ILH</b>	<b>Billy Venenciano</b> <b>Matt Ha</b>

### Boys Individual Winners

Weight	Name	School	Weight	Name	School
103 lbs	Nick Matayoshi	Iolani	152	T.J. Kuahine	Baldwin
112	Aaron Ishikawa	Iolani	160	Ryan "Bulla" Tuzon	Baldwin
119	Landon Kurata	Waiakea	171	Gerritt Vincent	KS-Kapalama
125	Brandon Low	Saint Louis	189	Jonathan Duquette	Roosevelt
130	Brendan Whitt	Punahou	215	Dylan Rush	Konawaena
135	Daniel Morita	Kahuku	275	Matt Tanielu	Molokai
140	Johanson Quist	Hilo			
145	Willie Smithe	Mililani			

### Girls Individual Winners

Weight	Name	School	Weight	Name	School
98 lbs	Kira Tamashiro	Iolani	125	Danica Kamakana	Moanalua
103	Carla Watase	Iolani	130	Kara Takasaki	Punahou
108	Joleen Oshiro	Iolani	140	Summer Alo	Kahuku
114	Cory Arisumi	Roosevelt	155	Delijah Joung	Waipahu
120	Shyla Iokia	Baldwin	175	Tilana Kawa	KS-Kapalama
			220	Randolyn Nohara	KS-Kapalama

## HHSAA Wrestling State Tournament Records

<b><u>Year</u></b>	<b><u>Champion School</u></b>	<b><u>Score</u></b>	<b><u>League</u></b>	<b><u>Coach</u></b>
2006	(boys) Kahuku (girls) Kahuku	188.5 143	OIA OIA	Reggie Torres Reggie Torres

Boys Individual Winners

<u>Weight</u>	<u>Name</u>	<u>School</u>	<u>Weight</u>	<u>Name</u>	<u>School</u>
103 lbs	Bryson Fukushima	Punahou	152	William Smythe	Mililani
112	Brandon Mina	Waipahu	160	Bryson Vivas	KS- Kapalama
119	Travis Okano	Lahainaluna	171	Mike Egesdal	Punahou
125	Landon Kurata	Waiakea	189	Gerritt Vincent	KS-Kapalama
130	Brandon Low	St. Louis	215	Jaren Silva-Purcell	St. Louis
135	Daniel Chow	Punahou	275	Dylan Rush	Ka'u
140	Bailey Ball	Lahainaluna			
145	Nicholas Pait	Pearl City			

Girls Individual Winners

<u>Weight</u>	<u>Name</u>	<u>School</u>	<u>Weight</u>	<u>Name</u>	<u>School</u>
98 lbs	Candace Sakamoto	Castle	125	Ashley Poling	Kaiser
103	Carla Watase	Iolani	130	Mysia Kamakaala	Kahuku
108	Megan Morisada	Iolani	140	Kara Takasaki	Punahou
114	Tani Ader	Farrington	155	Alicia Fu	Moanalua
120	Cherae Pascua	Mililani	175	Desiree Memea	University
			220	Randolyn Nohara	KS-Kapalama

<b><u>Year</u></b>	<b><u>Champion School</u></b>	<b><u>Score</u></b>	<b><u>League</u></b>	<b><u>Coach</u></b>
2007	(boys) Punahou (girls) Farrington	161.5 144	ILH OIA	Matt Oney Darren Reyes

Boys Individual Winners

<u>Weight</u>	<u>Name</u>	<u>School</u>	<u>Weight</u>	<u>Name</u>	<u>School</u>
103 lbs	Jordan Lai	St. Louis	152	Lake Casco	Lahainaluna
112	Mark Caberto	St. Louis	160	Lowen Tynanes-Perez	Campbell
119	Brandon Mina	Waipahu	171	Landon Kerbow	King Kekaulike
125	Travis Okano	Lahainaluna	189	Daymon Carr	Kahuku
130	Keani Nishigaya	St. Louis	215	Kazden Ikehara	KS-Kapalama
135	Kelii Palencia	KS-Kapalama	275	Mike Mullen	Leilehua
140	Daniel Chow	Punahou			
145	Richard Torres	Kahuku			

Girls Individual Winners

<u>Weight</u>	<u>Name</u>	<u>School</u>	<u>Weight</u>	<u>Name</u>	<u>School</u>
98 lbs	Renee Michell	Kealakehe	125	Danica Auna	Kahuku
103	Keiko Akamine	Iolani	130	Piikea Kalalau	Baldwin
108	Samantha Batoon	Farrington	140	Kara Takasaki	Punahou
114	Megan Morisada	Iolani	155	Monique Dilliner	Kailua
120	Tani Ader	Farrington	175	Ashlee Lilo	Farrington
			220	Randolyn Nohara	KS-Kapalama

## HHSAA Wrestling State Tournament Records

<u>Year</u>	<u>Champion School</u>	<u>Score</u>	<u>League</u>	<u>Coach</u>
<b>2008</b>	<b>(boys) Punahou</b>	<b>225.5</b>	<b>ILH</b>	<b>Matt Oney</b>
	<b>(girls) Kahuku</b>	<b>152.5</b>	<b>OIA</b>	<b>Reggie Torres</b>

### Boys Individual Winners

<u>Weight</u>	<u>Name</u>	<u>School</u>	<u>Weight</u>	<u>Name</u>	<u>School</u>
103 lbs	Drake Medeiros	St. Louis	152	Rudie Shaefer	Punahou
112	Shayden Terukina	KS-Kapalama	160	Lake Casco	Lahainaluna
119	Bill Takeuchi	Pearl City	171	Lowen Tynanes	Kailua
125	Reid Oshiro	Punahou	189	Brandon Santiago	Kealakehe
130	Travis Okano	Lahainaluna	215	Jamin Meletia	KS-Kapalama
135	Ryan Higa	Waiakea	275	Tyler Lauifi	Pearl City
140	Ray Matthewson	Waianae			
145	Daniel Chow	Punahou			

### Girls Individual Winners

<u>Weight</u>	<u>Name</u>	<u>School</u>	<u>Weight</u>	<u>Name</u>	<u>School</u>
98 lbs	Taylor Ibera	Farrington	125	Tani Ader	Farrington
103	Keiko Akamine	Iolani	130	Risha Mishima	Hawaii Baptist
108	Carronne Rozet	KS - Maui	140	Kuipo Badayos	Mililani
114	Crissy Chow	Punahou	155	Amanda Soliai	Kahuku
120	Danica Auna	Kahuku	175	Kailee Andrade	Baldwin
			220	Olivia Fatongia	Iolani

<u>Year</u>	<u>Champion School</u>	<u>Score</u>	<u>League</u>	<u>Coach</u>
<b>2009</b>	<b>(boys) Punahou</b>	<b>255.0</b>	<b>ILH</b>	<b>Matt Oney</b>
	<b>(girls) Punahou</b>	<b>150.5</b>	<b>ILH</b>	<b>Matt Oney</b>

### Boys Individual Winners

<u>Weight</u>	<u>Name</u>	<u>School</u>	<u>Weight</u>	<u>Name</u>	<u>School</u>
108 lbs	Jason Spiker	Kaiser	152	Raynald Cooper III	Pearl City
114	Truong Vu	Iolani	160	Kameona Hokoana	KS-Kapalama
120	Michael Nakagawa	Kaiser	171	Patrick Sheehan	Punahou
125	Reid Oshiro	Punahou	189	Tyson	
130	Maika Nagata	Punahou		Tynanes-Perez	Campbell
135	Jacob Luning-Hoshino	KS-Kapalama	215	George Kolu Buck	Punahou
140	Ian Akamine	Iolani	285	Jonathan	
145	Andy Chung	Iolani		Sanielia Fuimoano	Punahou

### Girls Individual Winners

<u>Weight</u>	<u>Name</u>	<u>School</u>	<u>Weight</u>	<u>Name</u>	<u>School</u>
98 lbs	Taylor Ibera	Farrington	125	Reiko Campos	KS-Kapalama
103	Malia Medeiros	KS-Maui	130	Robyn Teruya	Roosevelt
108	Macy Yonamine	KS-Kapalama	140	Jenny Ojerio	Punahou
114	Kelly Ann Ancheta	Pearl City	155	Ilima-Lei Macfarlane	Punahou
120	Joy Yamashita	Aiea	175	Justina Luafalemana	Molokai
			220	Olivia Fatongia	Iolani



## HHSAA Wrestling State Tournament Records

<u>Year</u>	<u>Champion School</u>	<u>Score</u>	<u>League</u>	<u>Coach</u>
<b>2010</b>	<b>(boys) Punahou</b>	<b>240.0</b>	<b>ILH</b>	<b>Matt Oney</b>
	<b>(girls) Punahou</b>	<b>146.5</b>	<b>ILH</b>	<b>Matt Oney</b>

### Boys Individual Winners

<u>Weight</u>	<u>Name</u>	<u>School</u>	<u>Weight</u>	<u>Name</u>	<u>School</u>
108 lbs	Cassidy Oshiro	Maryknoll	152	Holden Mowat	Lahainaluna
114	Jordan Ng	Punahou	160	Raynald Cooper III	Pearl City
120	David Terao	Mid-Pacific	171	Punahale Soriano	Kahuku
125	Todd Murakawa	Punahou	189	Tyson	
130	Shayden Terukina	KS-Kapalama		Tynanes-Perez	Campbell
135	Jacob Luning-Hoshino	KS-Kapalama	215	Marcus Finau	Damien
140	Galen McCleary	Punahou	285	Jheryl Makaiau	Kahuku
145	Ian Akamine	Iolani			

### Girls Individual Winners

<u>Weight</u>	<u>Name</u>	<u>School</u>	<u>Weight</u>	<u>Name</u>	<u>School</u>
98 lbs	Megan Aina	KS-Hawaii	125	Chrissy Chow	Punahou
103	Macy Yonamine	KS-Kapalama	130	Mindy Chow	Punahou
108	Bree Rapoza	KS-Kapalama	140	Anela Santiago	Aiea
114	Megan Yamaguchi	Kalani	155	Kaimana Lundquist	Punahou
120	Joy Yamashita	Aiea	175	Mei Ling Keiki	Pearl City
			220	Sanoe Spencer	Pearl City

<u>Year</u>	<u>Champion School</u>	<u>Score</u>	<u>League</u>	<u>Coach</u>
<b>2011</b>	<b>(boys) Punahou</b>	<b>210.0</b>	<b>ILH</b>	<b>Matt Oney</b>
	<b>(girls) Punahou</b>	<b>149.5</b>	<b>ILH</b>	<b>Matt Oney</b>

### Boys Individual Winners

<u>Weight</u>	<u>Name</u>	<u>School</u>	<u>Weight</u>	<u>Name</u>	<u>School</u>
108 lbs	Josh Terao	Mid-Pacific	145	Chanse Uyeda	Lahainaluna
114	Cassidy Oshiro	Maryknoll	152	Bryan Peralta	Punahou
120	Ryan Nakagawa	Kaiser	160	Jonathan Pico	King Kekaulike
125	David Terao	Mid-Pacific	171	Raynald Cooper III	Pearl City
130	Todd Murakawa	Punahou	189	Zachary Hernandez	Punahou
135	Shayden Terukina	KS-Kapalama	215	Jheryl Makaiau	Kahuku
140	Jacob Luning-Hoshino	KS-Kapalama	285	Akoakoa	
				Paleka-Kennedy	KS-Hawaii

### Girls Individual Winners

<u>Weight</u>	<u>Name</u>	<u>School</u>	<u>Weight</u>	<u>Name</u>	<u>School</u>
98 lbs	Allene Somera	Kailua	130	Mindy Chow	Punahou
103	Nicki Davis	KS-Maui	140	Rachel-Jean Factora	Campbell
108	Quinn Nagatani	Pacific Buddhist	155	Anela Santiago	Kahuku
114	Samantha Higa	Aiea	175	Darcie	
120	Marissa Fukunaga	Roosevelt		Manning-O'Brien	Aiea
125	Chrissy Chow	Punahou	220	Brayanne Moe	Radford

## HHSAA Wrestling State Tournament Records

<u>Year</u>	<u>Champion School</u>	<u>Score</u>	<u>League</u>	<u>Coach</u>
2012	(boys) Punahou (girls) Aiea	223.0 121.0	ILH OIA	Matt Oney Rick Williams

Boys Individual Winners

<u>Weight</u>	<u>Name</u>	<u>School</u>	<u>Weight</u>	<u>Name</u>	<u>School</u>
108 lbs	Braydon Akeo	Mililani	145	Blake Cooper	Pearl City
114	Cassidy Oshiro	Maryknoll	152	Bryan Peralta	Punahou
120	Sage Aoki	Konawaena	160	Laurent Remillard	Punahou
125	Joshua Terao	Mid-Pacific	171	Chaeden Grace Reyes	Farrington
130	Todd Murakawa	Punahou	189	Zachary Hernandez	Punahou
135	Chase Tantog	Mililani	215	Dane Pestano	KS-Kapalama
140	Austin Block	Kekaulike	285	Akoakoa Paleka-Kennedy	KS-Hawaii

Girls Individual Winners

<u>Weight</u>	<u>Name</u>	<u>School</u>	<u>Weight</u>	<u>Name</u>	<u>School</u>
98 lbs	Kaelynn Canyete	Kapolei	130	Mindy Chow	Punahou
103	Candice Segi	Aiea	140	Morgan Yamaguchi	Mililani
108	Quinn Nagatani	Pacific Buddhist	155	Joslynn Kahala Minczer	Nanakuli
114	Samantha Higa	Aiea	175	Darcie Manning-O'Brien	Aiea
120	Bree Rapoza	KS-Kapalama	220	Sanoe Spencer	Pearl City
125	Shannon Paaina	Mid-Pacific			

<u>Year</u>	<u>Champion School</u>	<u>Score</u>	<u>League</u>	<u>Coach</u>
2013	(boys) Kamehameha (girls) Pearl City	178.0 158.0	ILH OIA	Chris West Mike Lee

Boys Individual Winners

<u>Weight</u>	<u>Name</u>	<u>School</u>	<u>Weight</u>	<u>Name</u>	<u>School</u>
108 lbs	Brandon Perez	Campbell	145	Keamalu Richardson	Kamehameha
114	Treytan Kobayashi	Waialua	152	Blake Cooper	Pearl City
120	Alex Ursua	University	160	Laurent Remillard	Punahou
125	Braydon Akeo	Mililani	171	Chaeden Grace Reyes	Farrington
130	Joshua Terao	Mid-Pacific	189	Ikea Ikehara	Kamehameha
135	Jonathan Kamakana	Kamehameha	215	Dane Pestano	Kamehameha
140	Harry Jaramillo	Lahainaluna	285	Jariyn Villegas	Leilehua

Girls Individual Winners

<u>Weight</u>	<u>Name</u>	<u>School</u>	<u>Weight</u>	<u>Name</u>	<u>School</u>
97 lbs	Thai Ha Ioan	Punahou	121	Angela Lee	Mililani
101	Kaelynn Canyete	Kapolei	125	Harmony Pacheco	Kamehameha
105	Breanne Takaesu	Pearl City	130	Teshya Alo	Kamehameha
109	Aarica Barcina	Kahuku	135	Carly Jaramillo	Lahainaluna
113	Xandria Ford	Pearl City	140	Zoe Hernandez	Punahou
117	Bree Rapoza	Kamehameha	155	Janelle Fuamatu	Pearl City
			175	Welina Tong	Kamehameha
			220	Lalelei Mataafa	Lahainaluna

## HHSAA Wrestling State Tournament Records

<u>Year</u>	<u>Champion School</u>	<u>Score</u>	<u>League</u>	<u>Coach</u>
<b>2014</b>	<b>(boys) Pearl City</b>	<b>155.5</b>	<b>OIA</b>	<b>Mike Lee</b>
	<b>(girls) Kamehameha Kapalama</b>	<b>174.0</b>	<b>ILH</b>	<b>Pablo Billy Venenciano</b>

### Boys Individual Winners

Weight	Name	School	Weight	Name	School
106 lbs	Cameron Kato	Punahou	152	Jacob Solomon	Kalaheo
113	Chance Ikei	Kaiser	160	Blake Cooper	Pearl City
120	Christian Natividad	Campbell	170	Rodney Williams	Castle
126	Alex Ursua	Pearl City	182	Moses Wiseman	Kapolei
132	Joshua Terao	Mid-Pacific	195	Boman Tokioka	KS-Kapalama
138	Braydon Akeo	Mililani	220	Tristan Ludiazo	Campbell
145	Bubba Jaramillo	Lahainaluna	285	Jordan Fuamatu	Pearl City

### Girls Individual Winners

Weight	Name	School	Weight	Name	School
97 lbs	Maia Phanthadara	Roosevelt	121	Harmony Pacheco	KS-Kapalama
101	Kalissa Pundyke	Campbell	125	Shannon Paaaina	Mid-Pacific
105	Angela Enos	Moanalua	130	Teshya Alo	KS-Kapalama
109	Tammy Le	McKinley	135	Brenna Dudoit Vasquez	Lahainaluna
113	Donavyn Futa	KS-Kapalama	140	Carly Jaramillo	Lahainaluna
117	Shana Dilliner	KS-Kapalama	155	Jocelyn Tabion	Kapolei
			175	Erin Scheidt	KS-Kapalama
			220	Lalelei Mataafa	Lahainaluna

---

<u>Year</u>	<u>Champion School</u>	<u>Score</u>	<u>League</u>	<u>Coach</u>
<b>2015</b>	<b>(boys) Lahainaluna</b>	<b>158.5</b>	<b>MIL</b>	<b>Todd Hayase/Conrad Bolor</b>
	<b>(girls) Lahainaluna</b>	<b>203.5</b>	<b>MIL</b>	<b>Todd Hayase/Conrad Bolor</b>

### Boys Individual Winners

Weight	Name	School	Weight	Name	School
106 lbs	Corey Cabanban	Saint Louis	152	Liam Corbett	Leilehua
113	Triston Santos	Campbell	160	Connor Villarmia	Damien
120	Blaysen Terukina	KS-Kapalama	170	Thomas Rosen St. John	Lahainaluna
126	Shandon Ilaban Totten	Kapolei	182	Joseph Hoshino	KS-Kapalama
132	Chance Ikei	Kaiser	195	Boman Tokioka	KS-Kapalama
138	Robert Campos	Lahainaluna	220	Jackson Fuamatu	Pearl City
145	Brian Pascua	Iolani	285	Tristan Ludiazo	Campbell

### Girls Individual Winners

Weight	Name	School	Weight	Name	School
97 lbs	Bailey Hoshino	Punahou	127	Asia Lien Evans	Pearl City
102	Kyla Aruda	Kekaulike	132	Teshya Alo	KS-Kapalama
107	Alexis Encinas	Lahainaluna	138	Breanna Dudoit-Vasquez	Lahainaluna
112	Diamond Freitas	Lahainaluna	145	Carly Jaramillo	Lahainaluna
117	Alexis Ford	Pearl City	155	Avei Lualemaga	Aiea
122	Teniyā Alo	Iolani	168	Callan Medeiros	KS-Kapalama
			184	Jocelyn Alo	Kahuku
			225	Lalelei Mataafa	Lahainaluna

## HHSAA Wrestling State Tournament Records

---

<u>Year</u>	<u>Champion School</u>	<u>Score</u>	<u>League</u>	<u>Coach</u>
<b>2016</b>	<b>(boys) Iolani</b>	<b>166.0</b>	<b>ILH</b>	<b>Walden Au</b>
	<b>(girls) Kamehameha Kapalama</b>	<b>216.5</b>	<b>ILH</b>	<b>Pablo Venenciano</b>

Boys Individual Winners

<u>Weight</u>	<u>Name</u>	<u>School</u>	<u>Weight</u>	<u>Name</u>	<u>School</u>
106 lbs	Logan Garcia	Moanalua	152	Liam Corbett	Leilehua
113	Corey Cabanban	Saint Louis	160	Thomas Stevenson	Baldwin
120	Jake Nakasone	Iolani	170	Connor Villarmia	Damien
126	Cameron Kato	Punahou	182	Caleb Cardus	Waianae
132	Blaysen Terukina	KS-Kapalama	195	Miach Tynanes	Campbell
138	Baylen Cooper	Pearl City	220	James Sullivan	Campbell
145	Joshua Ray Gallarde	Campbell	285	Dane Yamshiro	Iolani

Girls Individual Winners

<u>Weight</u>	<u>Name</u>	<u>School</u>	<u>Weight</u>	<u>Name</u>	<u>School</u>
97 lbs	Menjam Tamang	Roosevelt	132	Teshya Alo	KS-Kapalama
102	Ashley Gooman	KS-Kapalama	138	Pomaikai Yamaguchi	KS-Kapalama
107	Iverly Navarro	Lahainaluna	145	Angela Peralta	Radford
112	Macy Higa	Roosevelt	155	Kelani Corbett	Leilehua
117	Donavyn Futa	KS-Kapalama	168	Cendall Manley	Molokai
122	Tehani Carlson	Waianae	184	Leilani Cmargo Naone	KS-Kapalama
127	Asia Evans	Pearl City	225	Lalelei Mataafa	Lahainaluna

---

<u>Year</u>	<u>Champion School</u>	<u>Score</u>	<u>League</u>	<u>Coach</u>
<b>2017</b>	<b>(boys) Iolani</b>	<b>164.5</b>	<b>ILH</b>	<b>Walden Au</b>
	<b>(girls) Lahainaluna</b>	<b>191.0</b>	<b>MIL</b>	<b>Todd Hayase/Conrad Bolor</b>

Boys Individual Winners

<u>Weight</u>	<u>Name</u>	<u>School</u>	<u>Weight</u>	<u>Name</u>	<u>School</u>
106 lbs	Kainoa Torigoe	Iolani	152	Makoa Cooper	Pearl City
113	Kysen Terukina	KS-Kapalama	160	Brandon Burgos	Aiea
120	Corey Cabanban	St. Louis	170	Brian Pascua	Iolani
126	Triston Santos	Campbell	182	Brett Barefoot	Leilehua
132	Zayren Terukina	Campbell	195	Saiaga Fautanu	Iolani
138	Ke'ale Keliinoi	Waianae	220	Micah Tynanes-Perez	Campbell
145	Brian Pascua	Iolani	285	Dane Yamashiro	Iolani

Girls Individual Winners

<u>Weight</u>	<u>Name</u>	<u>School</u>	<u>Weight</u>	<u>Name</u>	<u>School</u>
97 lbs	Ira Navarro	Lahainaluna	132	Teniya Alo	Kahuku
102	Brianna Leong	Leilehua	138	Kauanoa Keahi	Lahainaluna
107	Ashley Gooman	KS-Kapalama	145	Angela Peralta	Radford
112	Alexis Encinas	Lahainaluna	155	Kelani Corbett	Leilehua
117	Nanea Estrella	Lahainaluna	168	Ivory Ayers	Keaau
122	Czarina Pineda-Abaya	Kalani	184	Jennie Fuamatu	Pearl City
127	Jahnea Miguel	Baldwin	225	Lavenia Fotu	Farrington

---

## HHSAA Wrestling State Tournament Records

<u>Year</u>	<u>Champion School</u>	<u>Score</u>	<u>League</u>	<u>Coach</u>
2018	(boys) Leilehua (girls) Baldwin	156.0 157.5	OIA MIL	Kevin Corbett Race Hozaki

### Boys Individual Winners

Weight	Name	School	Weight	Name	School
106 lbs	Coby Ravida	Baldwin	152	Branden Pagurayan	Kapolei
113	Elijah Asuncion	Moanalua	160	Rysan Leong	Kalaheo
120	Kysen Terukina	KS-Kapalama	170	Kaysen Takenaka	Iolani
126	Corey Cabanban	St. Louis	182	Brett Barefoot	Leilehua
132	Kainalu Estrella	Lahainaluna	195	Alize Wright	Campbell
138	Noah Wusstig	Moanalua	220	Laulii Iosefa	McKinley
145	Zayren Terukina	Campbell	285	Ezekiel Samuolu	McKinley

### Girls Individual Winners

Weight	Name	School	Weight	Name	School
97 lbs	Xiaolin Mai	Roosevelt	132	Paige Respicio	KS-Kapalama
102	Ira Navarro	Lahainaluna	138	Teniyā Alo	Kahuku
107	Sami Saribay	Lahainaluna	145	Jahnea Miguel	Baldwin
112	Tiare Ikei	Kaiser	155	Kelani Corbett	Leilehua
117	Macy Higa	Roosevelt	168	Kapoina Bailey	Konawaena
122	Nanea Estrella	Lahainaluna	184	Roxie Umu	Kealakehe
127	Waipuilani Estrella-Beauchamp-Baldwin		225	Tangiteina Niutupuivaha	Kahuku

<u>Year</u>	<u>Champion School</u>	<u>Score</u>	<u>League</u>	<u>Coach</u>
2019	(boys) KS-Kapalama (girls) KS-Kapalama	228.50 219.00	ILH ILH	Rob Hesia Rob Hesia

### Boys Individual Winners

Weight	Name	School	Weight	Name	School
106 lbs	Mason Stefanelli	Punahou	152	Branden Pagurayan	Kapolei
113	Coby Ravida	Baldwin	160	Boltyr Taam	Moanalua
120	Brant Porter	KS-Kapalama	170	Rysan Leong	Kalaheo
126	Kysen Terukina	KS-Kapalama	182	Zander Mauel	Punahou
132	Ansen Ursua	Saint Louis	195	Darius Mynar	KS-Kapalama
138	Kaena Desantos	Waianae	220	Legend Matautia	Punahou
145	Noah Wusstig	Moanalua	285	Iulio Antonio	McKinley

### Girls Individual Winners

Weight	Name	School	Weight	Name	School
97 lbs	Jazmyn Enriquez	Campbell	132	Waipuilani Estrella Beauchamp	Lahainaluna
102	Tianna Fernandez	Baldwin	138	Paige Respicio	KS-Kapalama
107	Shantelle Mangrobang	Leilehua	145	Sadie Antoque	Castle
112	Alizeih Villapando	Campbell	155	Shayna Kamaka	Baldwin
117	Alana Vivas	KS-Kapalama	168	Kelani Corbett	Leilehua
122	Ashley Gooman	KS-Kapalama	184	Shannon Jaramillo	Lahainaluna
127	Nanea Estrella	Lahainaluna	225	Tangiteina Niutupuivaha	Kahuku

## HHSAA Wrestling State Tournament Records

<u>Year</u>	<u>Champion School</u>	<u>Score</u>	<u>League</u>	<u>Coach</u>
<b>2020</b>	<b>(boys) KS-Kapalama</b>	<b>207.50</b>	<b>ILH</b>	<b>Rob Heslia</b>
	<b>(girls) KS-Kapalama</b>	<b>169.00</b>	<b>ILH</b>	<b>Rob Heslia</b>

### Boys Individual Winners

<u>Weight</u>	<u>Name</u>	<u>School</u>	<u>Weight</u>	<u>Name</u>	<u>School</u>
106 lbs	Nicholas Cordeiro	Waianae	152	Kanai Tapia	KS-Kapalama
113	Tobey Ravida	Baldwin	160	Kamalu Anahu	KS-Hawaii
120	Coby Ravida	Baldwin	170	Manala Wolfgramm	KS-Kapalama
126	Brant Porter	KS-Kapalama	182	Blaze Pascua	Iolani
132	Kysen Terukina	KS-Kapalama	195	Zander Manuet	Punahou
138	Brady Hoshino	Iolani	220	Harry Lloyd	Kaimuki
145	Blaze Sumiye	Moanalua	285	Legend Matautia	Punahou

### Girls Individual Winners

<u>Weight</u>	<u>Name</u>	<u>School</u>	<u>Weight</u>	<u>Name</u>	<u>School</u>
97 lbs	Erin Hikiji	Mililani	132	Nanea Estrella	Lahainaluna
102	Brianna Funakoshi	Aiea	138	Paige Respicio	KS-Kapalama
107	Alejandra Corral	Aiea	145	Tiare Carlson	Waianae
112	Haley Narahara	KS-Kapalama	155	Sadie Antoque	Castle
117	Victoria Lee	Mililani	168	Shayna Kamaka	Baldwin
122	Emily Paulino	Kalani	184	Shannon Jaramillo	Lahainaluna
127	Lana Perez	Moanalua	225	Leona Toledo	Hilo

<u>Year</u>	<u>Champion School</u>	<u>Score</u>	<u>League</u>	<u>Coach</u>
<b>2022</b>	<b>(boys) Moanalua</b>	<b>222.50</b>	<b>OIA</b>	<b>Lucas Misaki</b>
	<b>(girls) Moanalua</b>	<b>232.00</b>	<b>OIA</b>	<b>Sean Sakaida</b>

### Boys Individual Winners

<u>Weight</u>	<u>Name</u>	<u>School</u>	<u>Weight</u>	<u>Name</u>	<u>School</u>
106 lbs	Evan Kusumoto	KS-Kapalama	152	Xander Erolin	Hanalani
113	Cyrus Bucsit	St. Louis	160	Blaze Sumiye	Moanalua
120	Joseph Lathwood	Moanalua	170	Brycen Pagurayan	Kapolei
126	Mikah Labuanan	KS-Maui	182	Karter Nitahara	Moanalua
132	Tyger Taam	Moanalua	195	Blaze Holani	St. Louis
138	Kinau Mcbrayer	Kapolei	220	Vanderlei Young	Waianae
145	Justyce Mercado	Punahou	285	Scotty Dikilato	KS-Kapalama

### Girls Individual Winners

<u>Weight</u>	<u>Name</u>	<u>School</u>	<u>Weight</u>	<u>Name</u>	<u>School</u>
97 lbs	Erin Hikiji	Mililani	132	Teani Medeiros-Maielua	Lahainaluna
102	Liana Ferreira	Baldwin	138	Aubrie Molina	Pearl City
107	Madison Kalamu	Moanalua	145	Jahlia Miguel	Baldwin
112	Nohea Moniz	KS-Kapalama	155	Mehana Kapoi	KS-Kapalama
117	Isabelle Asuncion	Moanalua	168	Jadyn Crisostomo	Moanalua
122	Haley Narahara	KS-Kapalama	184	Catherine Asami	Lahainaluna
127	Lainey Eckart	KS-Hawaii	225	Maia Asera	Kahuku

## HHSAA Wrestling State Tournament Records

---

<b><u>Year</u></b>	<b><u>Champion School</u></b>	<b><u>Score</u></b>	<b><u>League</u></b>	<b><u>Coach</u></b>
2023	(boys) Kapolei (girls) Moanalua	163.5 245.0	OIA OIA	Sean Salter Sean Sakaida

Boys Individual Winners

<u>Weight</u>	<u>Name</u>	<u>School</u>	<u>Weight</u>	<u>Name</u>	<u>School</u>
106 lbs	Hunter Berger	St. Louis	152	Xander Erolin	Hanalani
113	Evan Kusumoto	KS-Kapalama	160	Adrian Lee	Mililani
120	Logan Lau	Mid-Pacific	170	Brycen Pagurayan	Kapolei
126	Brenden Sekulich	Punahou	182	Jonas Baekkeland	Moanalua
132	Mikah Labuanan	KS-Maui	195	Keawe Kane-Keahi	Lahainaluna
138	Tyger Taam	Moanalua	220	Rodstan Salangdron	Kapolei
145	Akoni Kaaialii	KS-Kapalama	285	Scotty Dikilato	KS-Kapalama

Girls Individual Winners

<u>Weight</u>	<u>Name</u>	<u>School</u>	<u>Weight</u>	<u>Name</u>	<u>School</u>
97 lbs	Adriana Daoang	Moanalua	132	Eloise Woolsey	Kapolei
102	Tristan Nitta	Mililani	138	Lainey Eckart	KS-Hawaii
107	Naiomi Kulukualani-Sales	Moanalua	145	Malia Kukahiwa	Hilo
112	Caelin Balansag	Roosevelt	155	Nohilani Kukahiwa	Moanalua
117	Isabelle Asuncion	Moanalua	168	Eden Baguio	Moanalua
122	Kivah Caballero	Lahainaluna	184	Jasmine Adiniwin	Moanalua
127	Jax Realin	KS-Kapalama	225	Maia Asera	Kahuku

---

## HHSAA Wrestling State Tournament Records

### SPECIAL RECOGNITION: 3 non-consecutive year State Champions

Shayden Terukina	Kamehameha-Kapalama	ILH	2008, 2010, 2011
Chrissy Chow	Punahou	ILH	2008, 2010, 2011
Bree Rapoza	Kamehameha-Kapalama	ILH	2010, 2012, 2013
Teniya Alo	Iolani/Kahuku	ILH/OIA	2015, 2017, 2018
Ashley Gooman	Kamehameha-Kapalama	ILH	2016, 2017, 2019

### SPECIAL RECOGNITION: 3 consecutive year State Champions

Tatsuhiko Hikiji	Kaimuki	OIA	1968, 1969, 1970
Tuinanau Ala	Waianae	OIA	1969, 1970, 1971
Leigh Tonai	Baldwin	MIL	1973, 1974, 1975
Willie Kamakana	Punahou	ILH	1976, 1977
	Kaiser	OIA	1978
Yoshi Honda	Radford	OIA	1981, 1982, 1983
Kale Flagg	Iolani	ILH	1983, 1984, 1985
Ben Terukina	Campbell	OIA	1984, 1985, 1986
Kevin Bellefeuille	St. Louis	ILH	1987, 1988, 1989
Lawrence Lee	St. Louis	ILH	1987, 1988, 1989
Spencer Sequin	St. Louis	ILH	1996, 1997, 1998
Travis Lee	St. Louis	ILH	1999, 2000, 2001
Saia Lotulelei	Maui	MIL	1999, 2000, 2001
Melissa Orden	McKinley	OIA	2000, 2001, 2002
Stephany Lee	Moanalua	OIA	2000, 2001, 2002
Ashley Gaspar	Nanakuli	OIA	2000, 2001, 2002
Iwalani Fonoimoana	Kamehameha	ILH	2000, 2001, 2002
Danyelle Hedin	Kailua	OIA	2002, 2003, 2004
Carla Watase	Iolani	ILH	2004, 2005, 2006
Dylan Rush	Konawaena	BIIF	2004, 2005
	Ka'u	BIIF	2006
Kara Takasaki	Punahou	ILH	2005, 2006, 2007
Tani Ader	Farrington	OIA	2006, 2007, 2008
Travis Okano	Lahainaluna	MIL	2006, 2007, 2008
Daniel Chow	Punahou	ILH	2006, 2007, 2008
Jacob Luning-Hoshino	Kamehameha-Kapalama	ILH	2009, 2010, 2011
Raynald Cooper III	Pearl City	OIA	2009, 2010, 2011
Cassidy Oshiro	Maryknoll	ILH	2010, 2011, 2012
Todd Murakawa	Punahou	ILH	2010, 2011, 2012
Mindy Chow	Punahou	ILH	2010, 2011, 2012
Blake Cooper	Pearl City	OIA	2012, 2013, 2014
Brayden Akeo	Mililani	OIA	2012, 2013, 2014
Carly Jaramillo	Lahainaluna	MIL	2013, 2014, 2015
Nanea Estrella	Lahainaluna	MIL	2017, 2018, 2019
Kysen Terukina	Kamehameha-Kapalama	ILH	2017, 2018, 2019

### SPECIAL RECOGNITION: 4-year State Champions

Patrick Higa	Iolani,	ILH,	1983, 1984, 1985, 1986
Jonathan Spiker	St. Louis	ILH,	2000, 2001, 2002, 2003
Caylene Valdez	Moanalua	OIA	2000, 2001, 2002, 2003
Brandon Low	St. Louis	ILH	2003, 2004, 2005, 2006
Randolyn Nohara	Kamehameha – Kapalama	ILH	2004, 2005, 2006, 2007
Joshua Terao	Mid-Pacific	ILH	2011, 2012, 2013, 2014
Teshya Alo	Kamehameha - Kapalama	ILH	2013, 2014, 2015, 2016
Lalelei Mataafa	Lahainaluna	MIL	2013, 2014, 2015, 2016
Corey Cabanban	Saint Louis	ILH	2015, 2016, 2017, 2018
Kelani Corbett	Leilehua	OIA	2016, 2017, 2018, 2019